

matki

EAUZONE
EWP

INSTALLATION

PARTS LIST

PLEASE PASS THE
GUARANTEE CARD ON TO
THE CUSTOMER

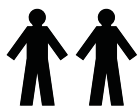

TWO PEOPLE
RECOMMENDED

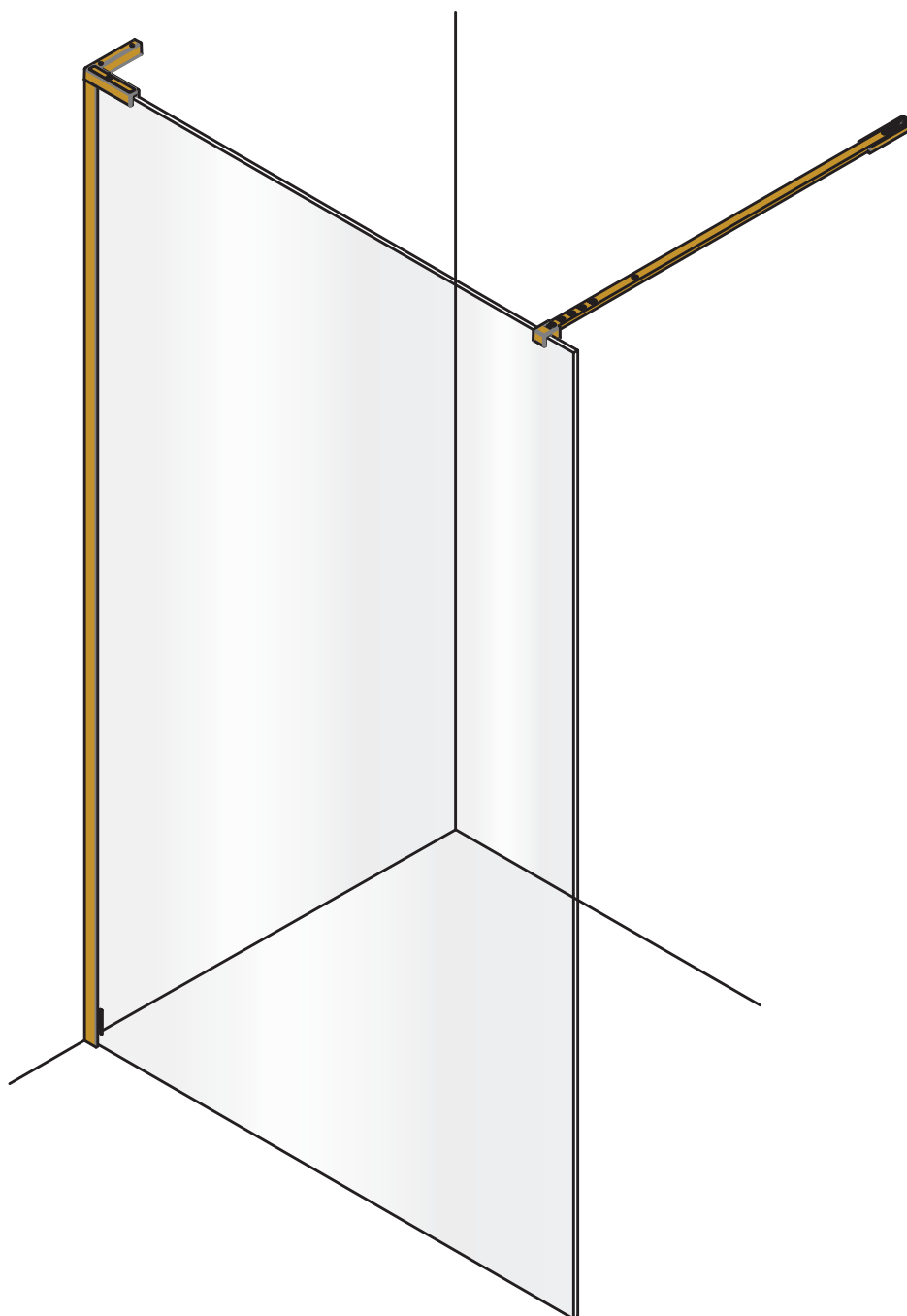

CE

UK
CA

matki

Matki PLC, Churchward Road, Yate,
Bristol BS37 5PL

BS EN 14428:2015+A1:2018

MATKI PLC, CHURCHWARD ROAD, YATE, BRISTOL, BS37 5PL
TELEPHONE: 01454 322888 (CUSTOMER SERVICES) EMAIL: techsupport@matki.co.uk

9898 AF 01/22

Matki recommend that this product is fitted by professional installers

IMPORTANT

TOOLS REQUIRED

Masonry Drill bit 6mm, Tape Measure, Screw Drivers, Safety Glasses, Allen Keys, Electric Drill, Level, Pencil, Adjustable Spanners, Non Slip Gloves

Before disposing of carton and/or commencing assembly, please check all the parts to ascertain that none are missing and they are all undamaged. No claim for missing/damaged parts will be accepted once the packing carton has been disposed of and/or assembly has commenced.

In case of query contact your Stockist with details of model number and details of serial number.

PREPARATION IMPORTANT

1. Please read complete installation instructions before fitting for enclosure and tray (if fitting).
2. We recommend that two people are available for fitting of Wetroom Panel, Stage 2. The **Eauzone Plus** range is **10mm Glass** construction. Large glass panels are very heavy. We recommend the use of safety glasses and non slip gloves when handling the glass panels.
3. Ensure that the product can be **fixed** to a **solid masonry wall** or suitable **timber stud work grade C16/C24** in the area behind the wall frames and panel fixing brackets.
4. Shower trays or tiled floors **must be absolutely level** where enclosures are fitted
5. If fitting a tray we recommend a **drainage test** is carried out before the tray is tiled in position.
6. The assembly should be installed onto a waterproof wall covering and installed after the tray and wall coverings are in place. Trays with tiling lips should be let into the wall with the tiling lip flush with the wall to allow the tiling to overlap the tiling lip.
7. Seal between tray and tiles. Remove any excess sealant from the area/joint between the tray and the tiles where the wall mount is to be fitted. This will ensure the wall mount fits correctly to the wall and tray/or tiled floor.

CAUTION: TEMPERED GLASS CANNOT BE CUT, POLISHED METAL AND CHROME CAN BE SCRATCHED. CAREFULLY REMOVE ASSEMBLY FROM CARTON, DO NOT PLACE GLASS ON HARD FLOOR OR EXPOSE EDGES TO IMPACT.

DIMENSIONS

Dimensions are approximate

MODEL	TOTAL WIDTH A	
	MIN	MAX
EWP200	165	180
EWP300	265	280
EWP400	365	380
EWP500	465	480
EWP600	565	580
EWP700	665	680
EWP760	725	740
EWP800	765	780
EWP900	865	880
EWP1000	965	980
EWP1100	1065	1080
EWP1200	1165	1180
EWP1300	1265	1280
EWP1400	1365	1380
EWP1500	1465	1480

Image shows LH
EWP1200 and upwards require
Brace Bar (supplied)

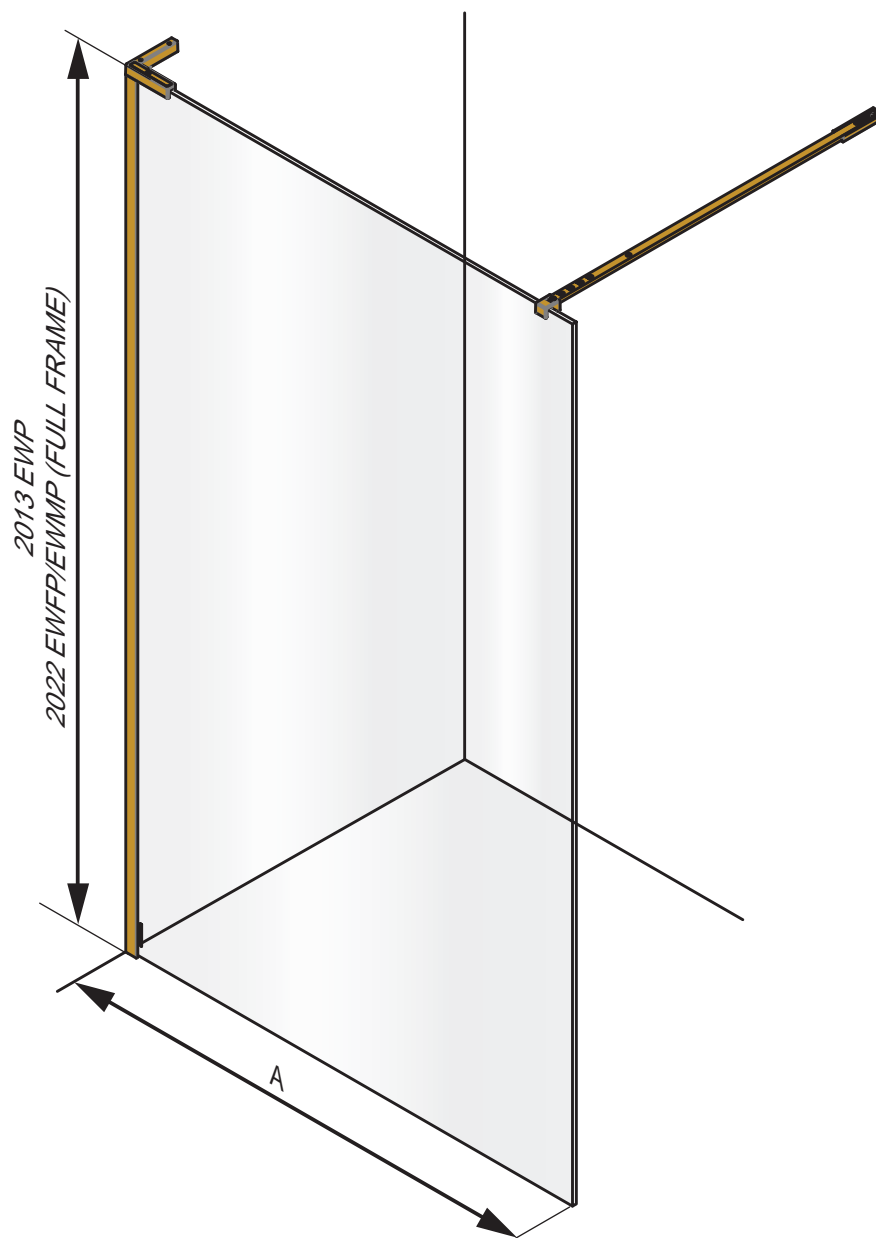

STAGE 1 - FITTING WALL MOUNT

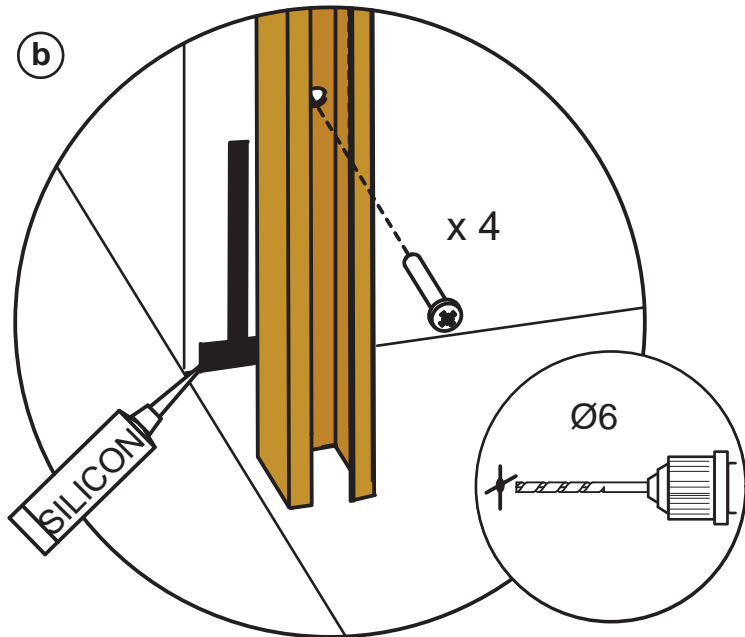
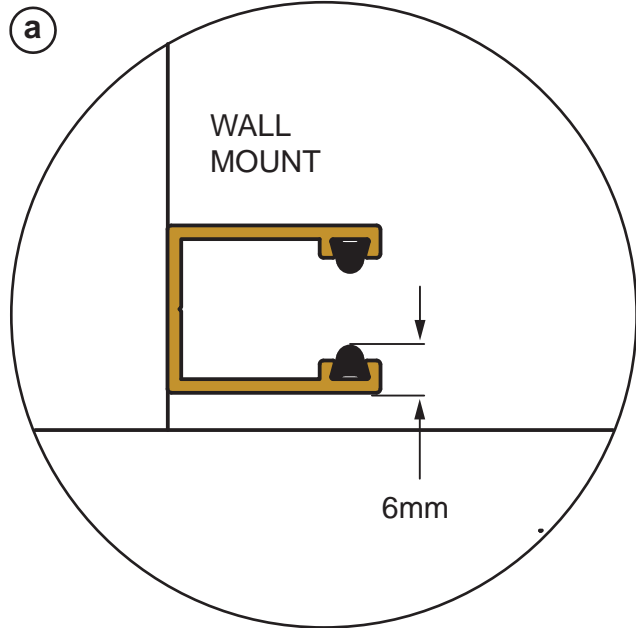

APPLY SILICON 'T'
100mm UP BEFORE FINAL
FITTING

No 8 x 32 (x 4)

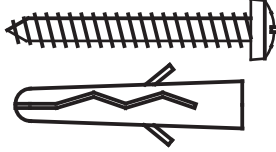

MARK HOLES x 4

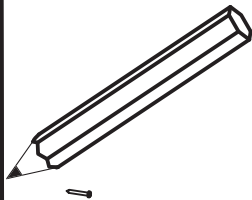

DRILL HOLES &
FIT PLUGS x 4
(CLEAN AREA
AFTER)

ENSURE WALL MOUNT IS PLUMB

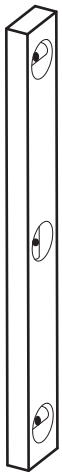

FOR EWP 1200 - 1500
REFER TO BRACE BAR
DIMENSIONS FOR
OVERALL WIDTH

STAGE 2 - FITTING GLASS

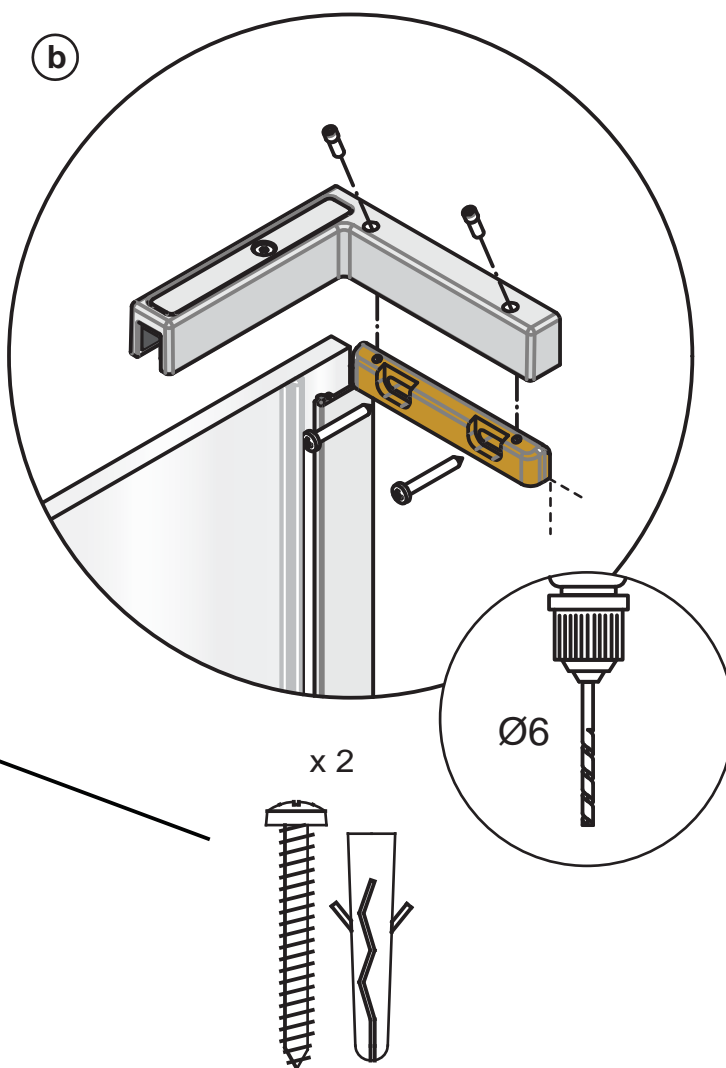
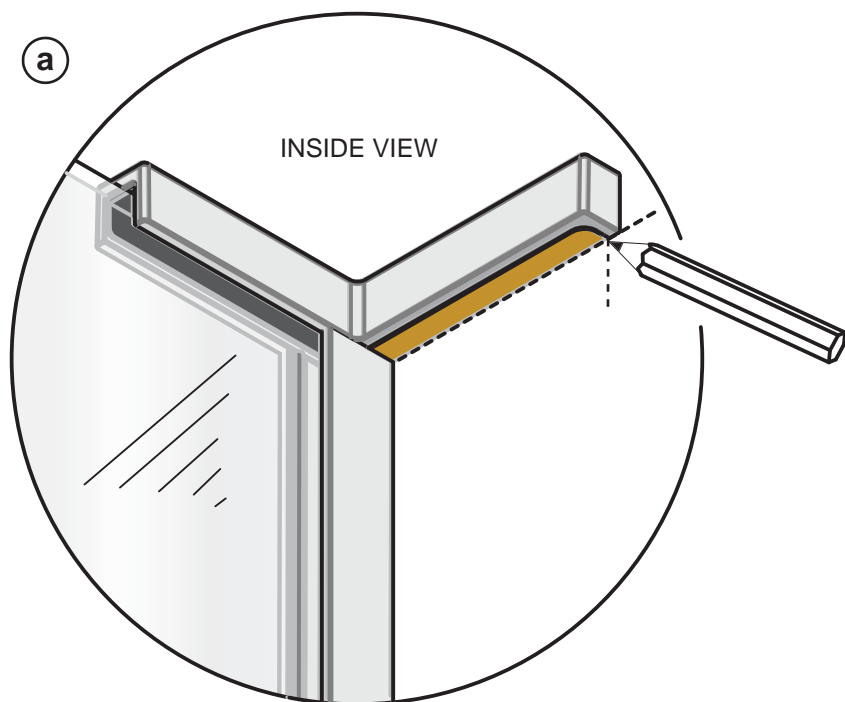
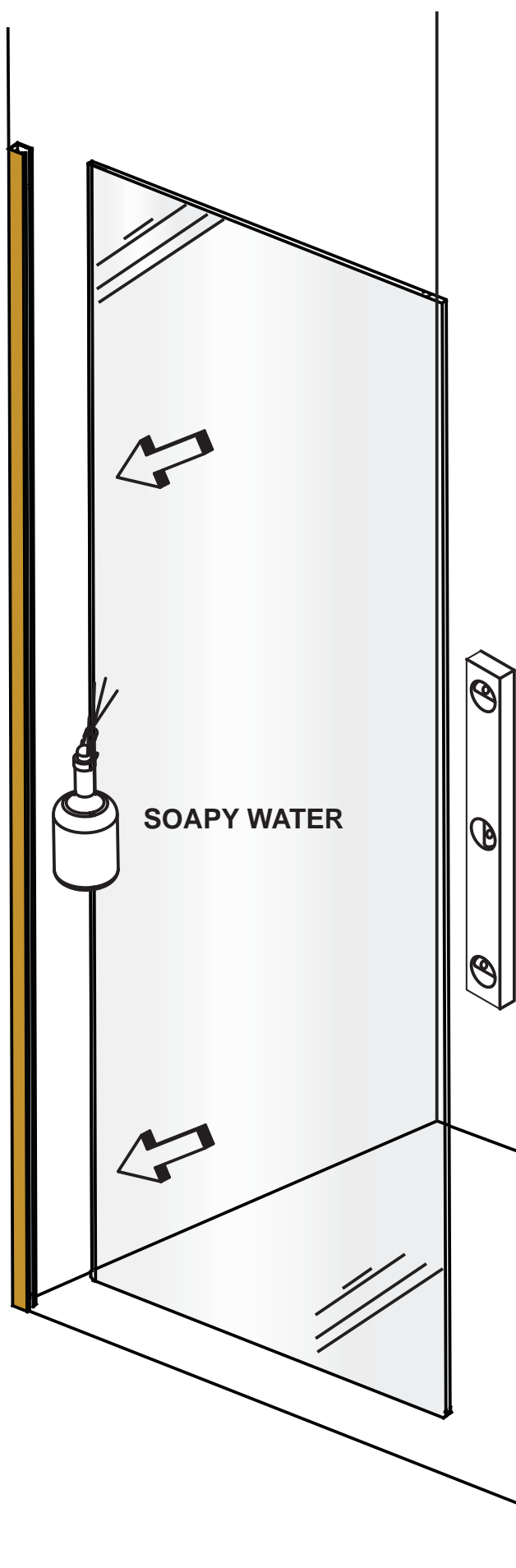

STAGE 3: SIZING THE BRACE BAR

BRACE ONLY REQUIRED FOR
MODEL SIZES 1200 AND OVER

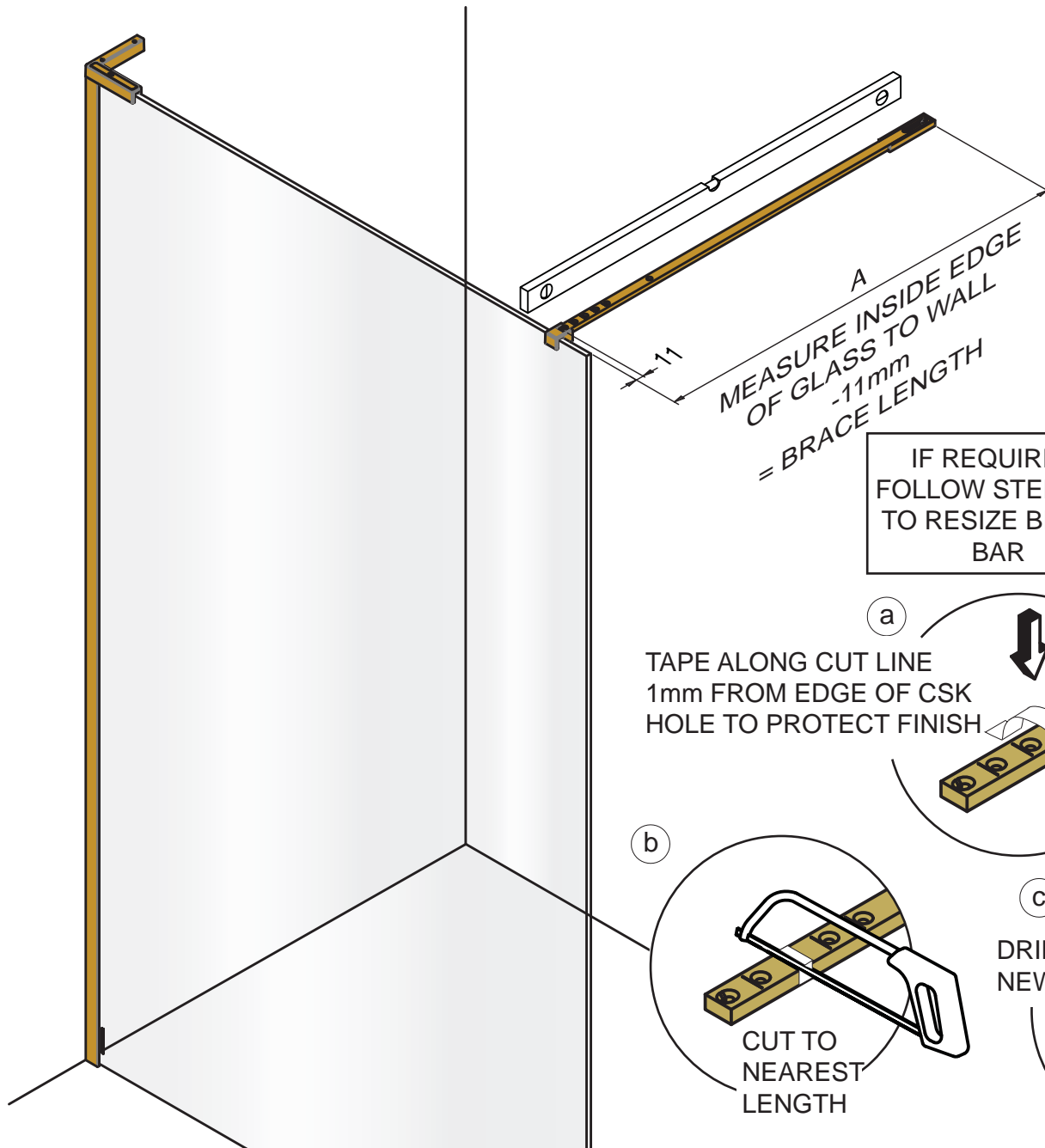
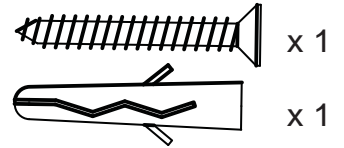

a
TAPE ALONG CUT LINE
1mm FROM EDGE OF CSK
HOLE TO PROTECT FINISH

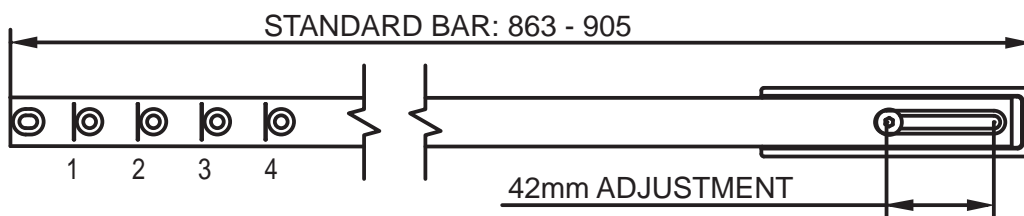
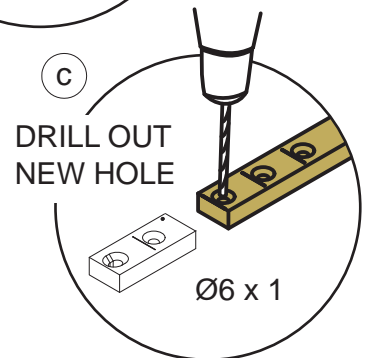
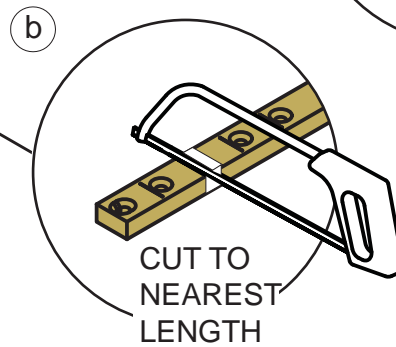
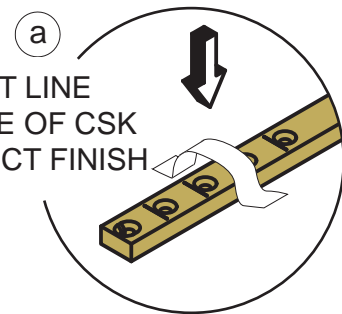

CUT POSITION
1: 838 - 880
2: 813 - 855
3: 788 - 830
4: 763 - 805

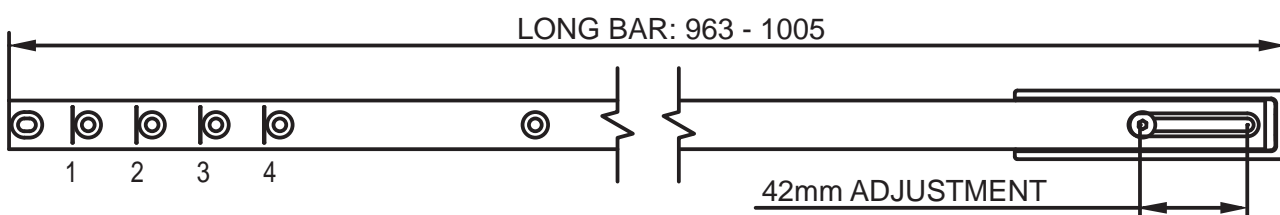

CUT POSITION
1: 938 - 980
2: 913 - 955
3: 888 - 930
4: 863 - 905

STAGE 4: FITTING THE BRACE BAR

BRACE ONLY REQUIRED FOR
MODEL SIZES 1200 AND OVER

MARK
BRACKET
AT WALL

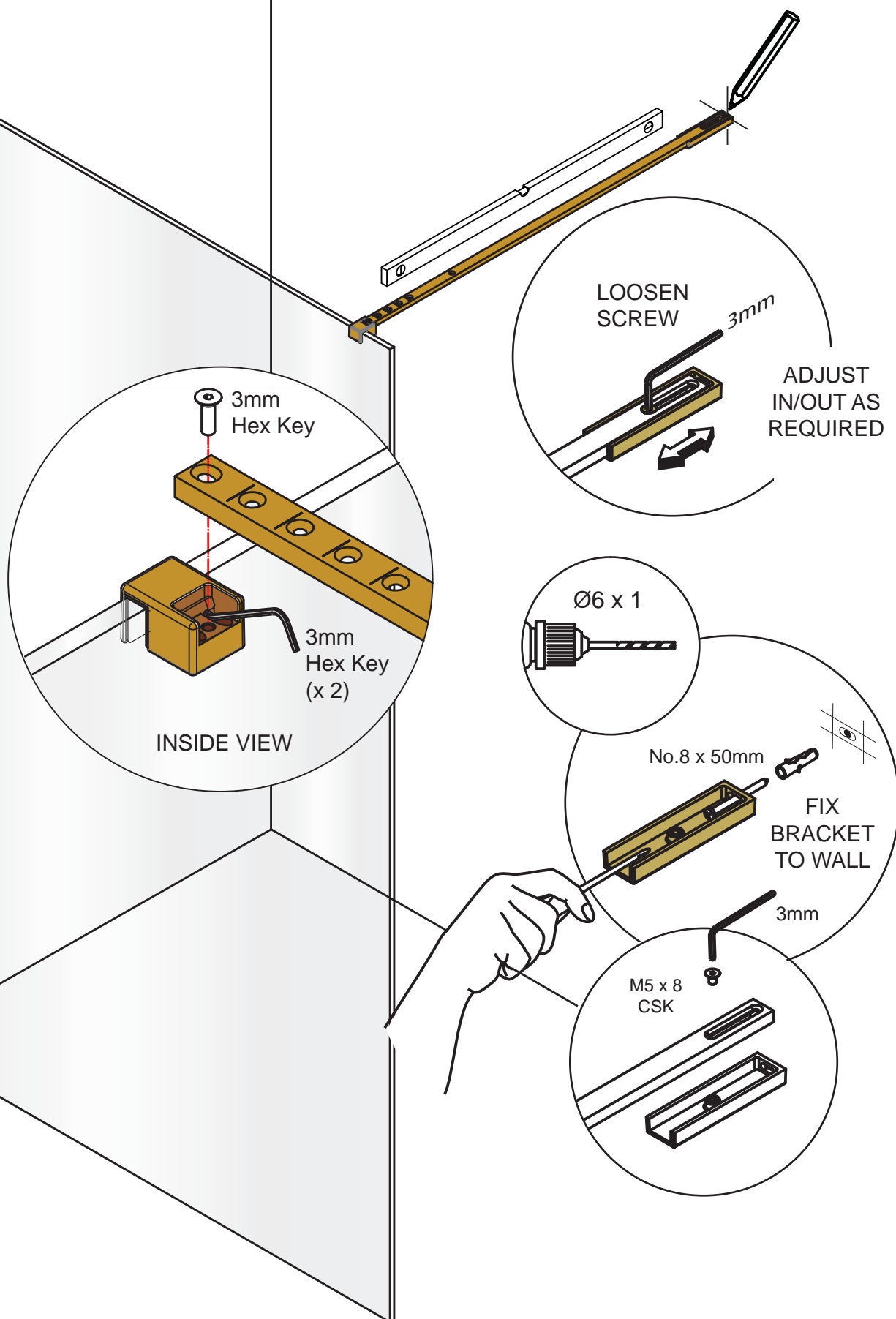

STAGE 5: SEALING

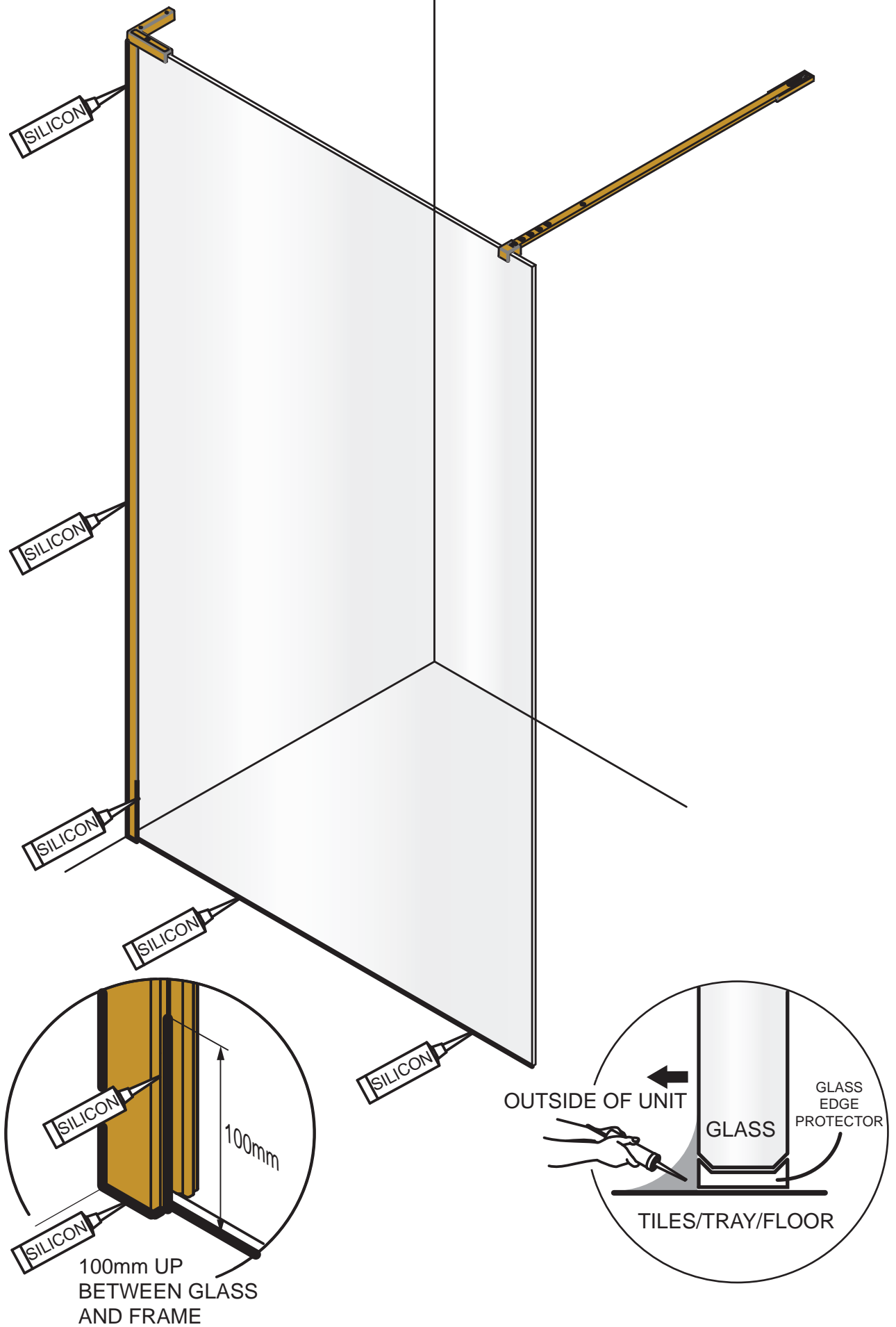

PARTS LIST

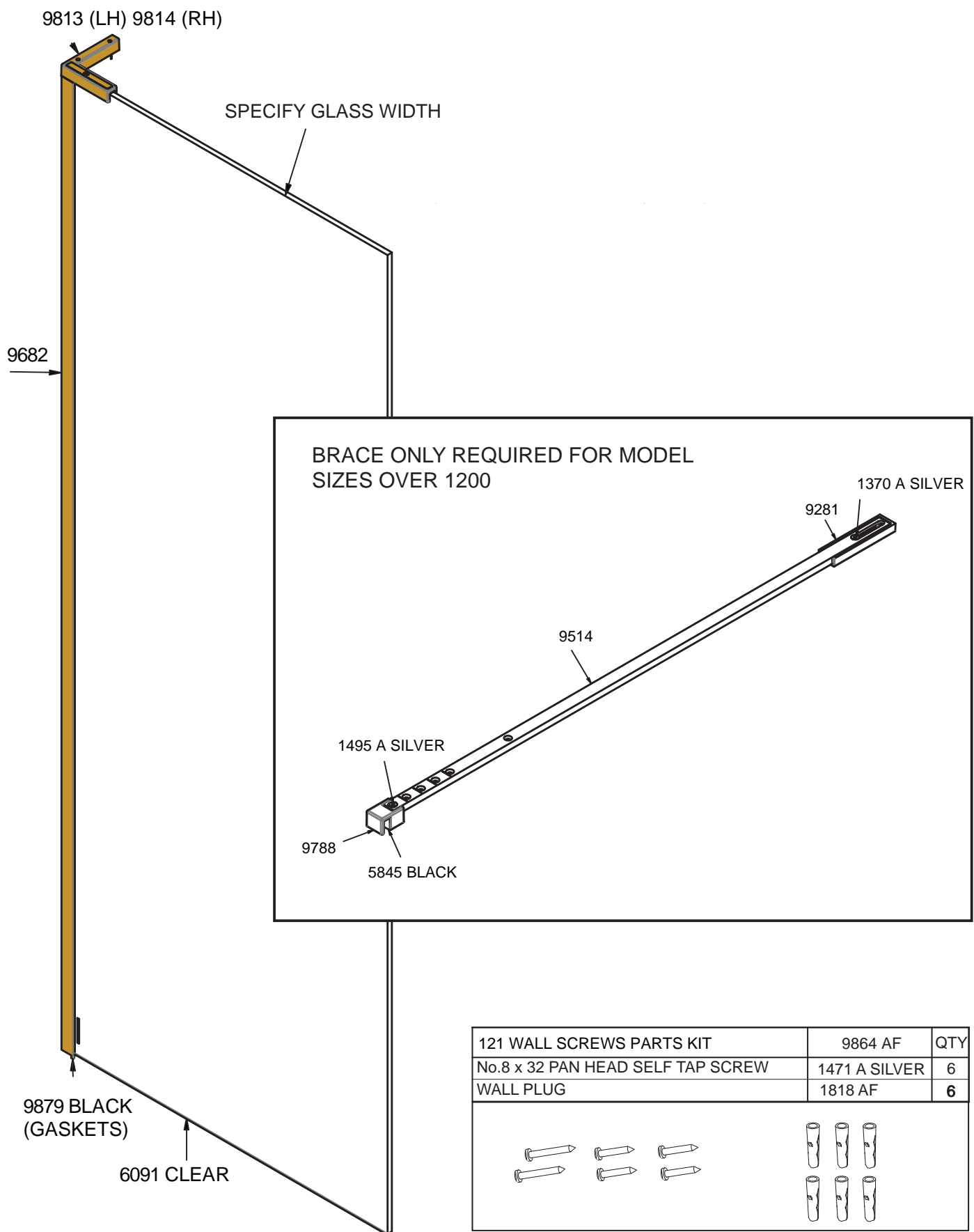

We recommend that these instructions are handed to the user with a note of a date of purchase and model details.
To order replacements quote:Part Descriptions, Model, Part Number and Colour.