

matki

MATKI ONE®

MOWT - TWIN ENTRANCE - BRACE BAR

INSTALLATION

PARTS LIST



TWO PEOPLE
RECOMMENDED

Please pass the
Guarantee Card
to the customer.



CE

matki

13

Matki PLC, Churchward Road, Yate,
Bristol BS37 5PL

EN 14428:2008+A1

MATKI PLC, CHURCHWARD ROAD, YATE, BRISTOL, BS37 5PL
TELEPHONE: 01454 322888 (CUSTOMER SERVICES) EMAIL: techsupport@matki.co.uk

IMPORTANT

TOOLS REQUIRED

Masonry Drill bit 6mm, Tape Measure, Screw Drivers, Safety Glasses, Electric Drill, Level, Pencil, Adjustable Spanners, Non Slip Gloves, Saw, 2.5mm Allen Key, 4mm Allen Key

Before disposing of carton and/or commencing assembly, please check all the parts to ascertain that none are missing and they are all undamaged. No claim for missing/damaged parts will be accepted once the packing carton has been disposed of and/or assembly has commenced.

In case of query contact your Stockist with details of model number and details of serial number.

PREPARATION IMPORTANT

1. Please read complete installation instructions before fitting for enclosure and tray (if fitting).
2. We recommend the use of safety glasses and non slip gloves when handling the glass panels.
3. Ensure that the product can be **fixed** to a **solid masonry wall** or suitable **timber stud work grade C16/C24** in the area behind the wall frames.
4. Shower trays or tiled floors **must be absolutely level** where enclosures are fitted
5. If fitting a tray we recommend a **drainage test** is carried out before the tray is tiled in position.
6. The assembly should be installed onto a waterproof wall covering and installed after the tray and wall coverings are in place. Trays with tiling lips should be let into the wall with the tiling lip flush with the wall to allow the tiling to overlap the tiling lip.
7. Seal between tray and tiles. Remove any excess sealant from the area/joint between the tray and the tiles where the wall mount is to be fitted. This will ensure the wall mount fits correctly to the wall and tray/or tiled floor.

CAUTION: TEMPERED GLASS CANNOT BE CUT, POLISHED METAL AND CHROME CAN BE SCRATCHED. CAREFULLY REMOVE ASSEMBLY FROM CARTON, DO NOT PLACE GLASS ON HARD FLOOR OR EXPOSE EDGES TO IMPACT. DO NOT CUT TOP TRACK IN ANY CIRCUMSTANCES.

DIMENSIONS

MATKI ONE: TWIN ENTRANCE: WALL BRACE BAR

MODEL	'A'
MOWT900	860mm
MOWT1000	950mm
MOWT1100	1050mm
MOWT1200	1150mm
MOWT1400	1350mm
MOWT1500	1450mm

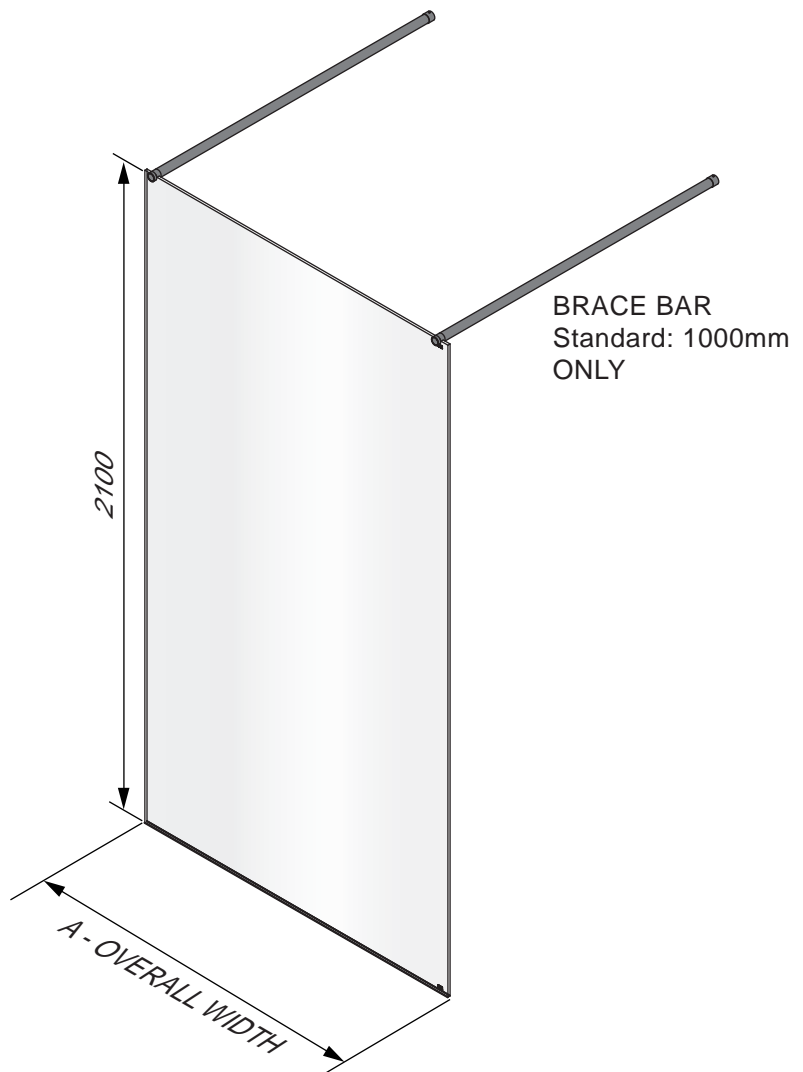
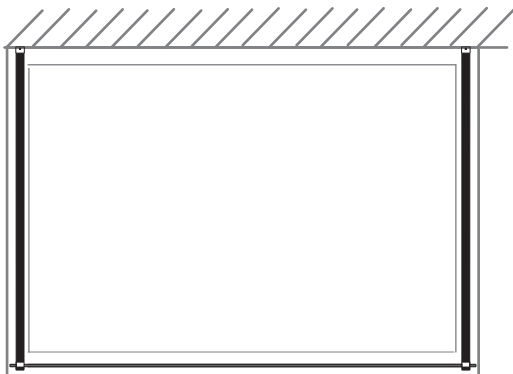

Dimensions are approximate

STAGE 1



TWO PEOPLE
RECOMMENDED

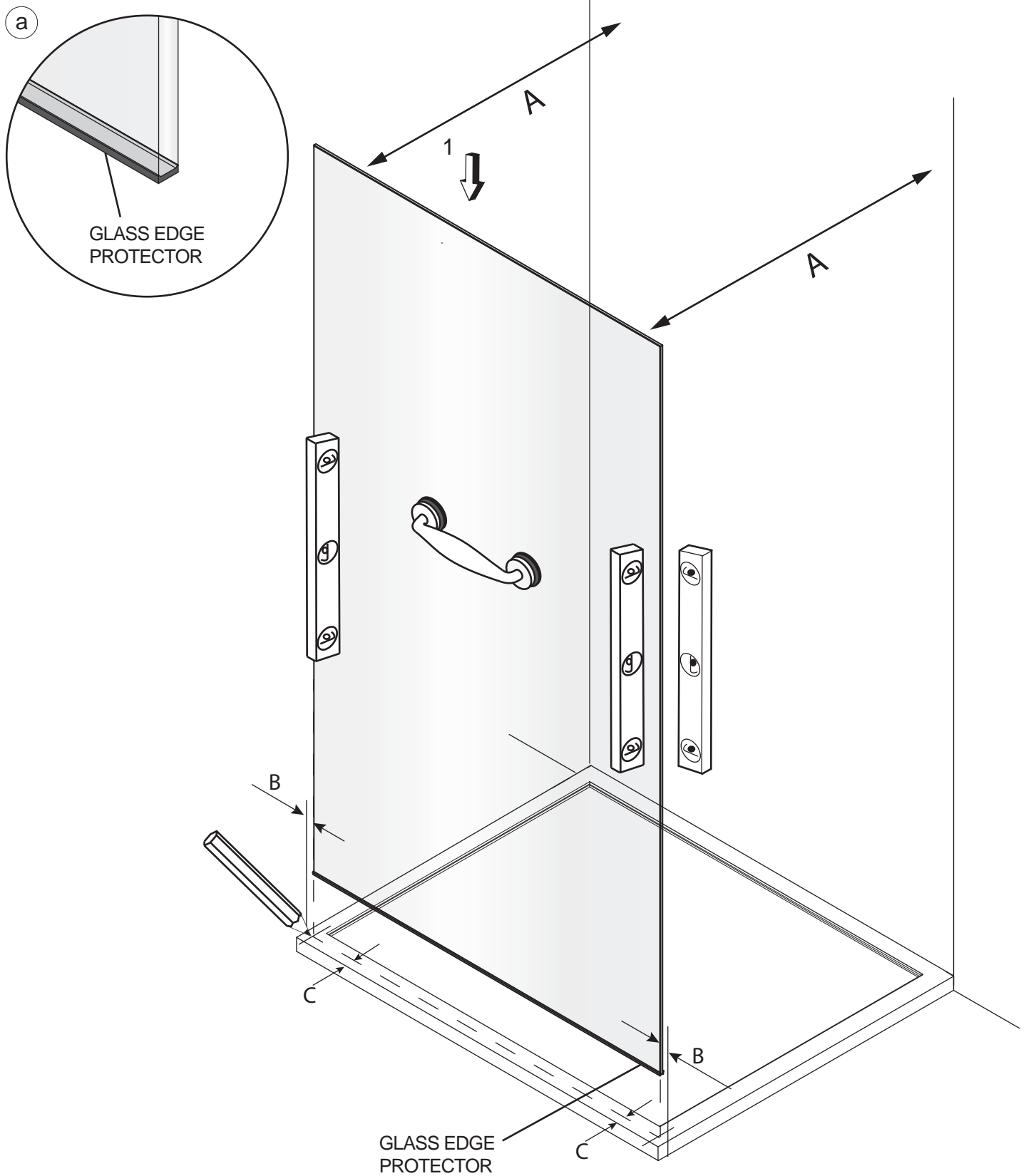

This stage is describing the positioning of the glass panel.

- a.** Make sure the glass guard edge is the downwards edge placed onto the tray.
- b.** Centre the panel on the tray or wetroom floor. Position as required. ($B=B / C=C$)
- c.** Mark the position of the panel for future reference.

STAGE 2

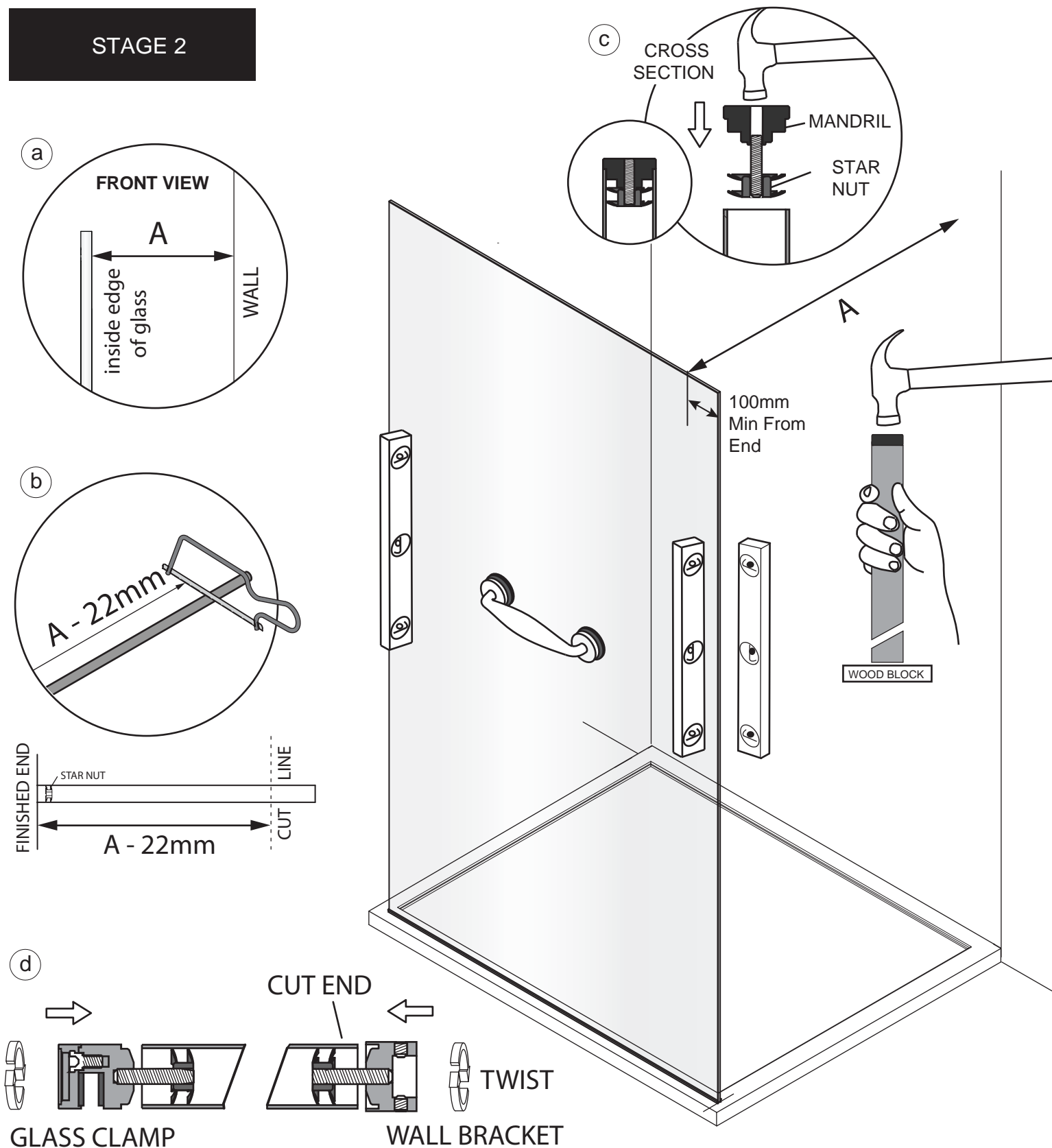

This stage is describing the fitting of the brace bar.

a. Measure the distance (A) between the inside edge of the glass panel and the opposite wall. Make sure you position 100mm from the end of the glass.

b. Measure and cut the brace bar down to the correct length ($A - 22\text{mm}$). Make sure to cut the end without a star nut inside.

c. Using a Hammer and Mandril (found in the kit of parts), tap the Start Nut (found in the kit of parts) into the cut end of the Brace Bar tube. Make sure the wings on the star nut are curved towards you, out of the tube.

TIP: Place the Brace Bar on a block of wood to protect the coated end from being damaged.

d. Twist the Glass Clamp assembly (found in the kit of parts) onto the coated/coloured end, which was uncut and had the star nut inside already.

STAGE 3

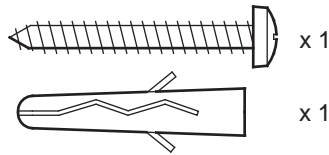

TWO PEOPLE
RECOMMENDED

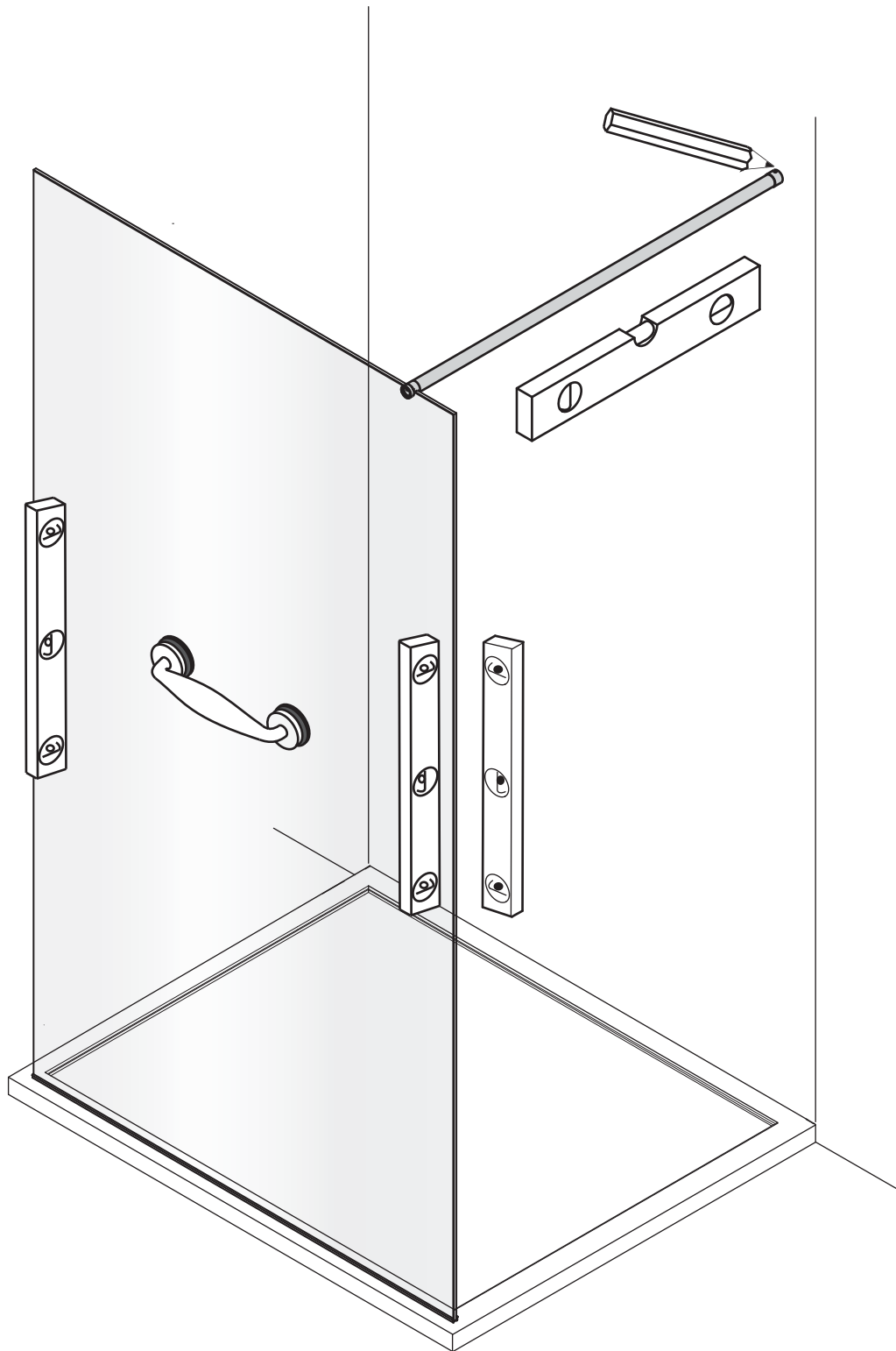
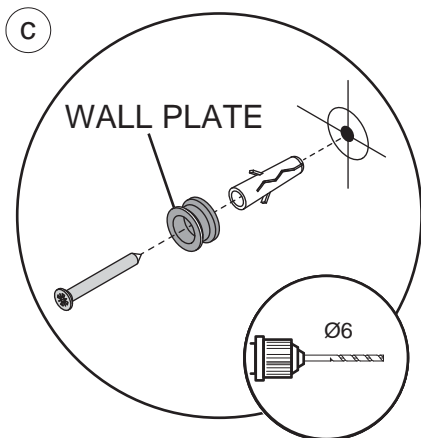
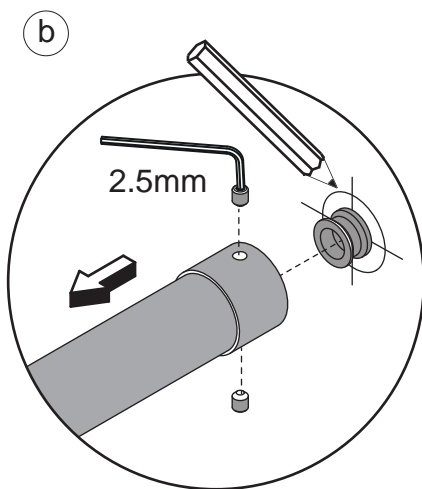
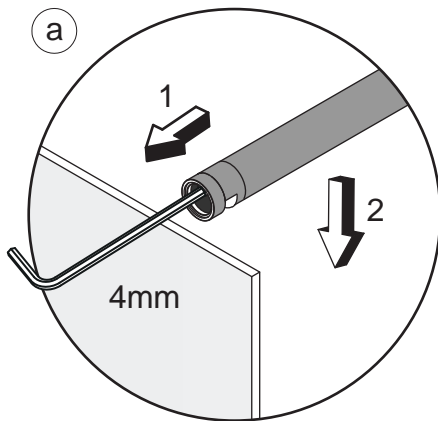

This stage is describing the fitting of the wall plate.

a. Fit the Brace Bar over the top of the glass panel. This may require loosening the Fixed Bracket using a 4mm Allen key.

b. Making sure the bar is Horizontal, mark on the wall around the Wall Plate. Remove the Brace Bar. Centralise the Wall Plate and mark the hole.

c. Drill 1 x fixing hole in the wall and insert wall plug. Clean the area. Then attach the Wall Plate using the No.8 x 32mm Pan Head Screw provided in the kit of parts.

STAGE 4

REPEAT STEPS 1-4
TO FIT OTHER
WALL BRACE

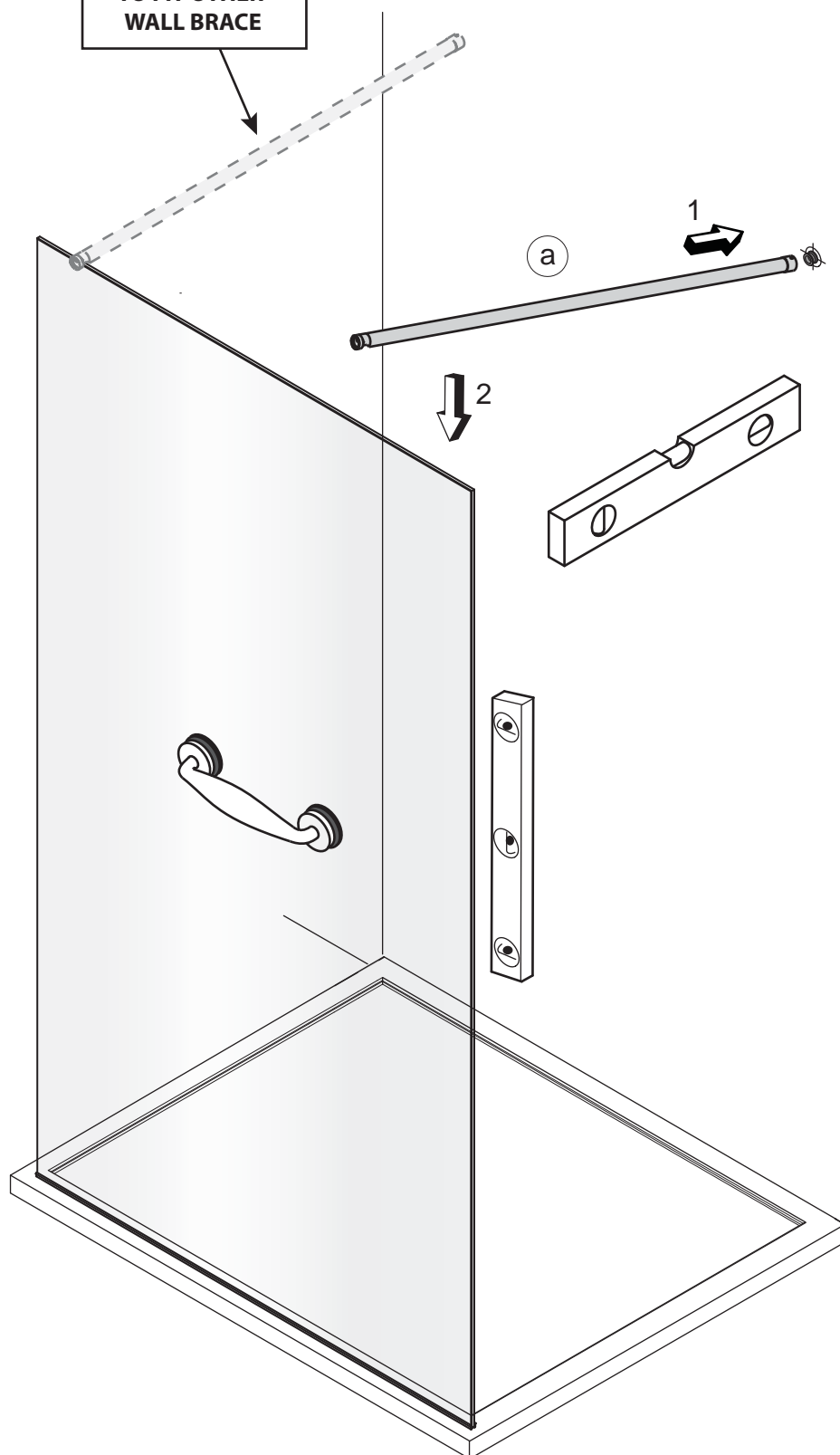
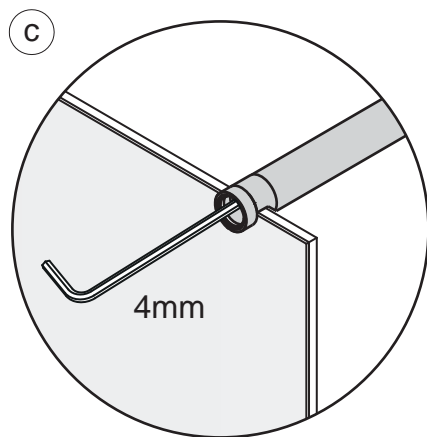
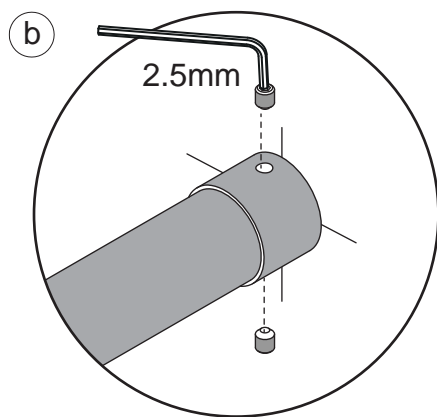

This stage is describing the fitting of the brace bar.

- a.** Slot the end of the Brace Bar over the Wall Plate first, then place the Fixed Bracket end over the top of the glass panel.
- b.** Secure the Brace Bar onto the Wall Plate by tightening the two grub screws using a 2.5mm Allen key.
- c.** Tighten the Fixed Bracket onto the glass panel using a 4mm Allen Key.
- d.** Repeat steps 1 - 4 to fit other ceiling brace

STAGE 5

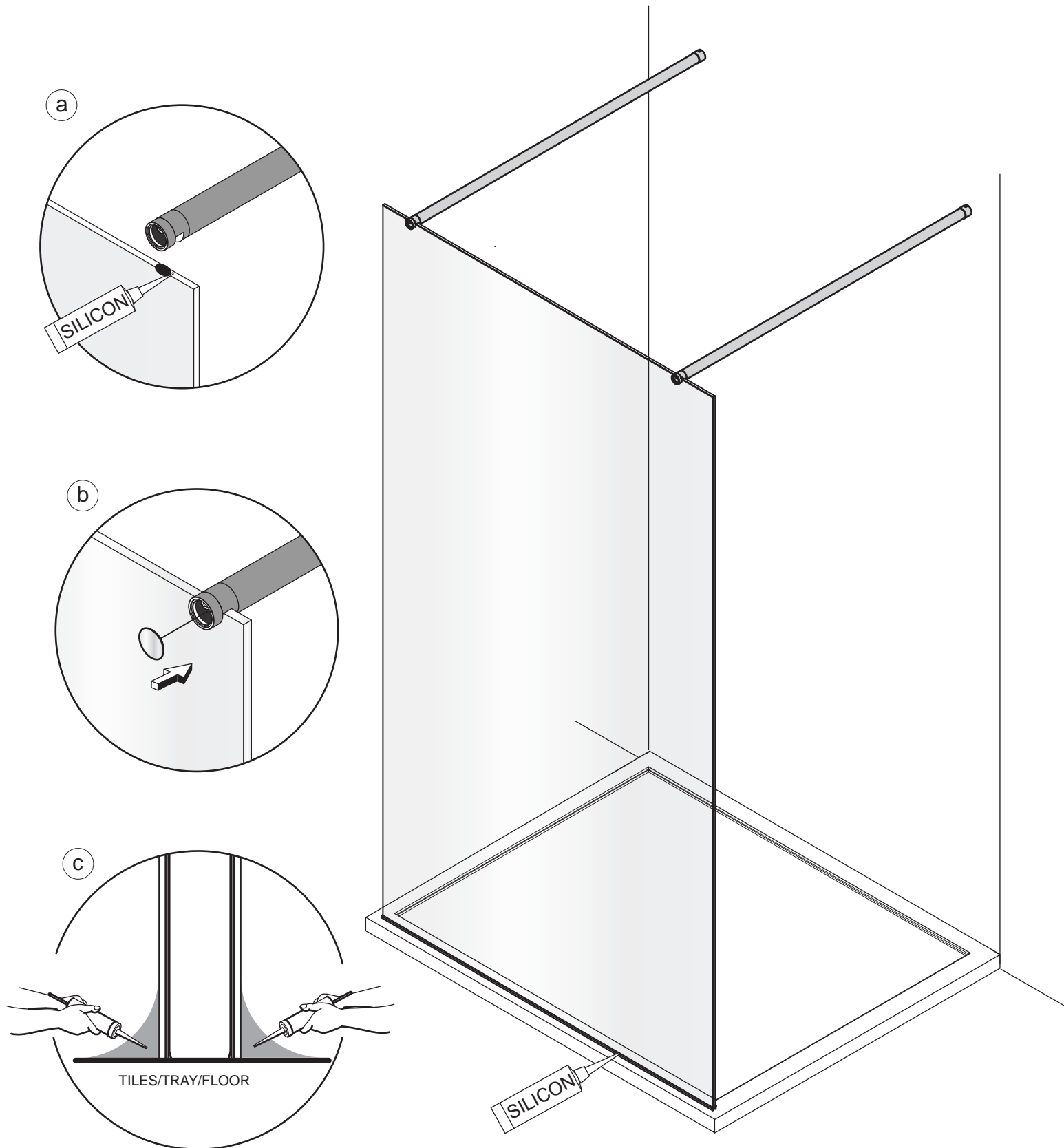

This stage is describing sealing of the unit.

- a.** Loosen the Fixed Bracket using a 4mm Allen Key. Lift and apply a small spot of silicone on the glass edge where the bracket rests. Press firmly down and tighten the Fixed Bracket back up. Repeat one brace at a time.
- b.** Fit the cover cap (supplied in the kit of parts), press firmly into the end of the brace bar.
- c.** Apply a thin bead of silicone along the bottom edge of the glass, inside and outside of the unit.

PARTS LIST

* COLOUR VARIANT ON PARTS

MOWP MAIN SLIDER PACK

ITEM	DESCRIPTION	PART No	QTY
1	STRAIGHT GLASS	3910 M CLEAR / PLAIN (MODEL 500) 3906 M CLEAR / PLAIN (MODEL 700) 3948 MGG CLEAR (MODEL 800) 3929 M CLEAR / PLAIN (MODEL 850) 3912 M CLEAR / PLAIN (MODEL 900) 3927 M CLEAR / PLAIN (MODEL 1000) 3907 M CLEAR / PLAIN (MODEL 1100) 3928 M CLEAR / PLAIN (MODEL 1200) 3908 M CLEAR / PLAIN (MODEL 1400) 3909 M CLEAR / PLAIN (MODEL 1500)	1
2	GLASS EDGE PROTECTOR	GLASS DEPENDENT	1

MOWP KIT OF PARTS 8912 AF/COPPER/BRASS x 2

ITEM	DESCRIPTION	PART No	QTY
*3	PANEL CLAMP BAR	8850 A SILVER / 8850 BLACK / 8850 C WHITE / 8850 M MILL	2
4	WALL PLATE	1485 AF	1
5	STAR FANGLED NUT M6 x 25 TUI095	TUI095 - OIL	1
6	M6 x 40 SOCKET SET SCREW	1515 A SILVER	1
7	WETROOM PANEL CLAMP PAD	8890 AF	2
*8	PANEL BRACE BAR CAP CLAMP	8697 A SILVER / 8697 BRASS / 8697 COPPER	1
*9	PANEL BRACE BAR CLAMP BODY	8695 A SILVER / 8695 BRASS/ 8695 COPPER	1
10	PIVOT BLOCK ADJUSTER SCREW	8261 AF	1
*11	BRACE BAR CLAMP BODY	8696 A SILVER / 8696 BRASS / 8696 COPPER	1
12	M5 x 6 SOCKET SET SCREW ST/ST	1502 A SILVER	2
13	TUBE MANDREL	8624 BLACK	1
*14	HANDLE CAP	8402 BLACK/ 8402 C WHITE/ 8400 A SILVER/ 8400 BRASS/ 8400 COPPER	1
15	M6 X 20 SOCKET CUP SCREW	1270 AF	1
16	DISC DETAIL PACK	7393 AF	1

SCREW KIT OF PARTS 8910 AF

ITEM	DESCRIPTION	PART No	QTY
17	CURVED WALL MOUNT CAP	8446 A SILVER	1
18	No. 8 x 32 PAN HEAD SCREW	1471 A SILVER	6
19	WALL PLUG	1818 AF	6
20	MATKI ONE MOWT INSTRUCTIONS	8917 AF	1

