

matki

BOUTIQUE WALK-IN WITH TRAY AND HINGE PANEL

INSTALLATION

PARTS LIST

MODELS WITH TRAY ONLY:

NWSC/H, NWSR/H, NWCC/H, NWST/H, NWSF/H

Please pass the
Guarantee Card
to the customer.

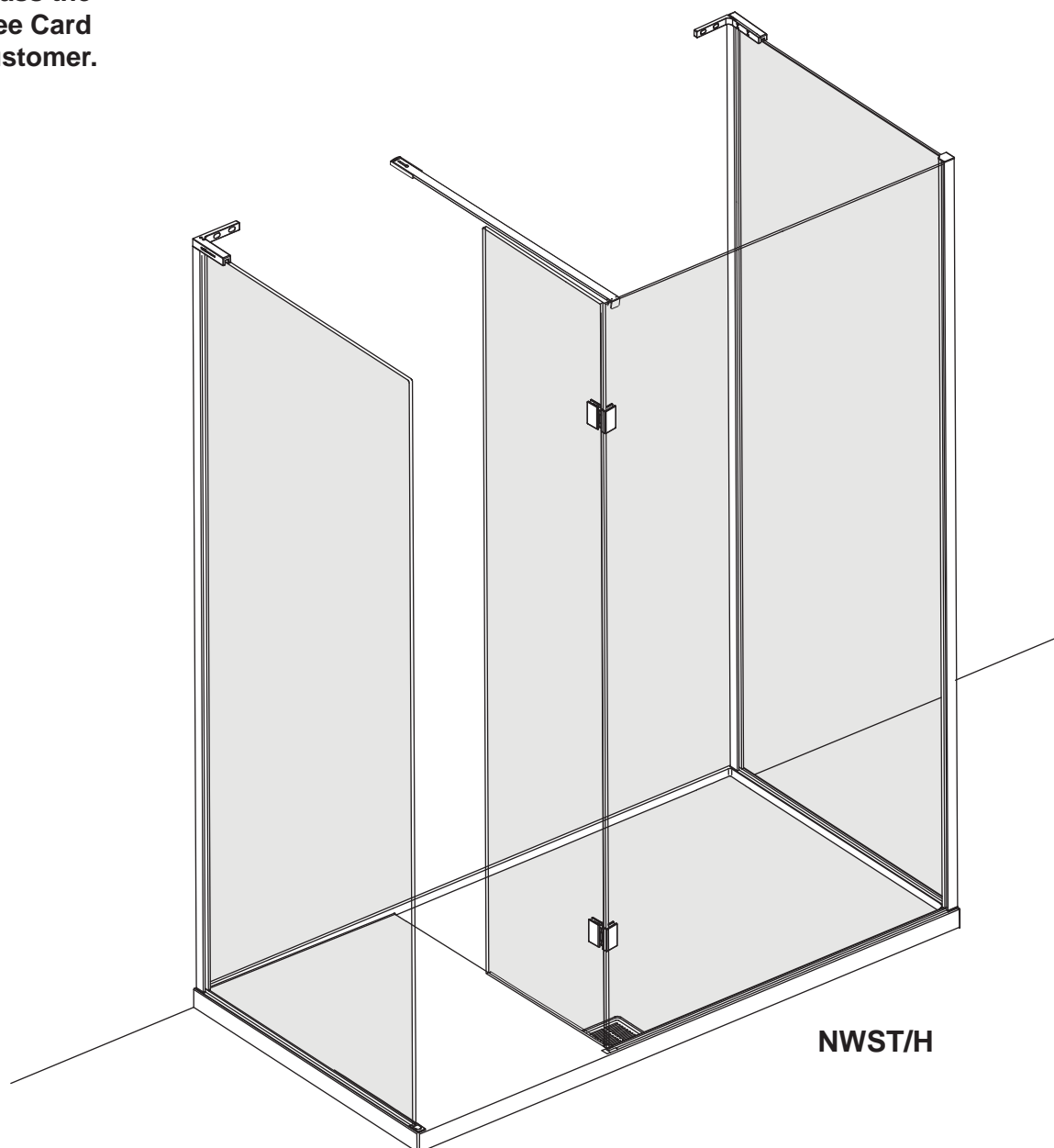

matki | SHOWERING

13

Matki PLC, Churchward Road, Yate,
Bristol BS37 5PL

EN 14428:2008+A1

MATKI PLC, CHURCHWARD ROAD, YATE, BRISTOL, BS37 5PL
TELEPHONE: 01454 322888 (CUSTOMER SERVICES). EMAIL: techsupport@matki.co.uk

0933 AF 06/21

IMPORTANT

TOOLS REQUIRED

Masonry Drill bit 6mm, Tape Measure, Screw Drivers, Safety Glasses, Allen Keys, Electric Drill, Level, Pencil, Adjustable Spanners, Non Slip Gloves

Before disposing of carton and/or commencing assembly, please check all the parts to ascertain that none are missing and they are all undamaged. No claim for missing/damaged parts will be accepted once the packing carton has been disposed of and/or assembly has commenced. In case of query contact your Stockist with details of model number and details of serial number.

PREPARATION IMPORTANT

1. Please read complete installation instructions before fitting the enclosure and tray (if fitting).
2. We recommend that two people are available for fitting of the glass panels.
The **Boutique Walk-in** range is **8 and 10mm Glass** construction. Large glass panels are very heavy. We recommend the use of safety glasses and non slip gloves when handling the glass panels.
3. Ensure that the product can be **fixed** to a **solid masonry wall** or suitable **timber stud work grade C16/C24** in the area behind the wall frames and panel fixing brackets.
4. Shower trays or tiled floors **must be absolutely level** where enclosures are fitted.
5. If fitting a tray we recommend a **drainage test** is carried out before the tray is tiled in position.
6. The assembly should be installed onto a waterproof wall covering and installed after the tray and wall coverings are in place.
Trays with tiling lips should be let into the wall with the tiling lip flush with the wall to allow the tiling to overlap the tiling lip.
7. Seal between tray and tiles. Remove any excess sealant from the area/joint between the tray and the tiles where the wall mount is to be fitted. This will ensure the wall mount fits correctly to the wall and tray/or tiled floor.

CAUTION: TEMPERED GLASS CANNOT BE CUT, POLISHED METAL AND CHROME CAN BE SCRATCHED. CAREFULLY REMOVE ASSEMBLY FROM CARTON, DO NOT PLACE GLASS ON HARD FLOOR OR EXPOSE EDGES TO IMPACT.

DIMENSIONS

Dimensions are approximate
Model shown NWST/TBH 1790LH

	A	B	C	D
MODEL 1290	1200mm	900mm	530mm	415mm
MODEL 1580	1500mm	800mm	530mm	465mm
MODEL 1590	1500mm	900mm	530mm	465mm
MODEL 1780	1700mm	800mm	580mm	515mm
MODEL 1790	1700mm	900mm	580mm	515mm

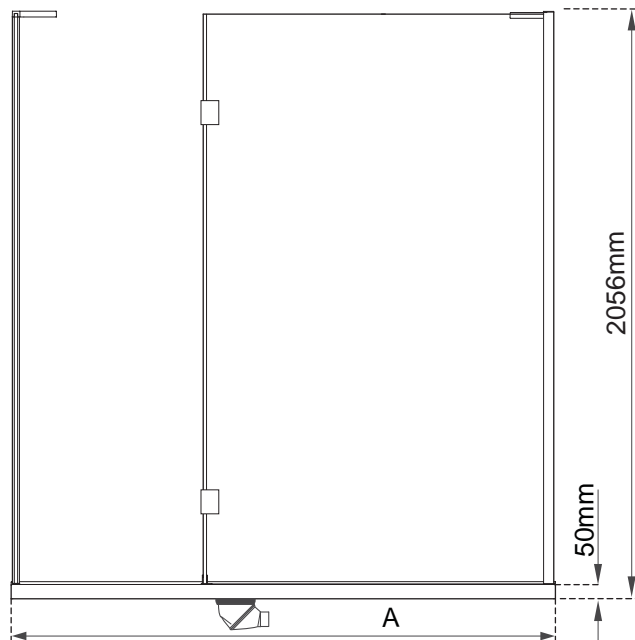
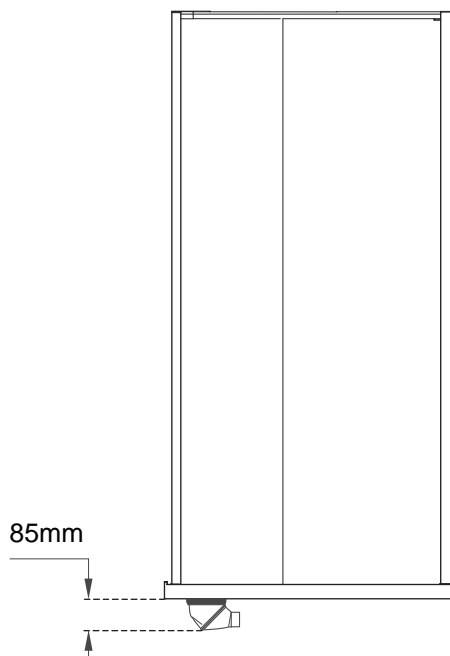
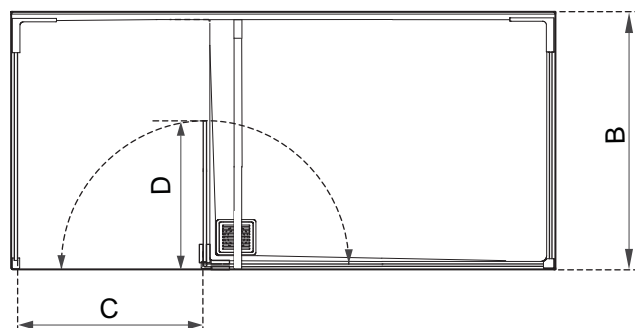

READ ONLY IF INSTALLING FLOOR MOUNTED TRAY

DIMENSIONS FOR TRAY

ILLUSTRATION SHOWS LH MODEL

TRAY MUST BE LEVEL
IN ALL PLANES

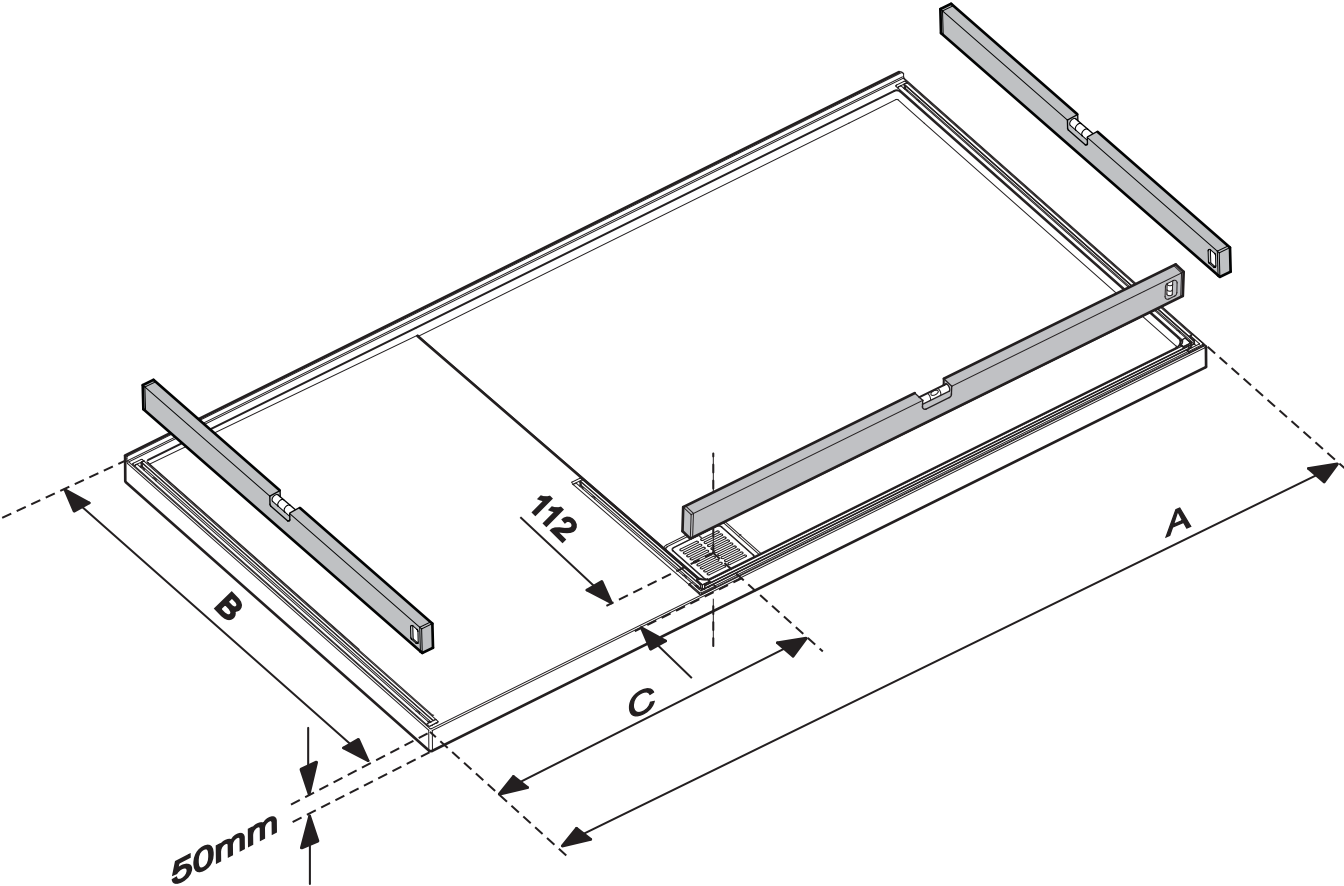
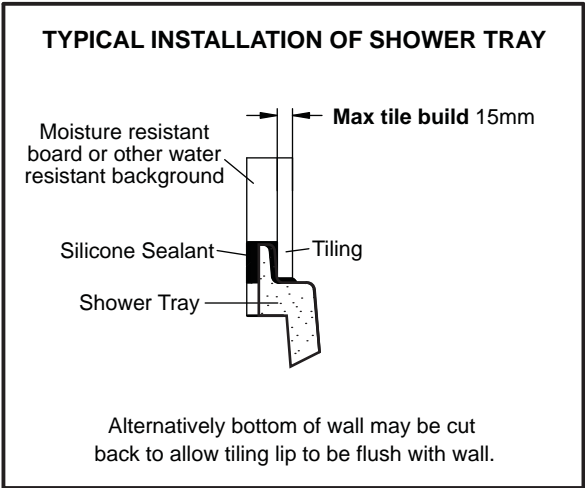

	A	B	C
MODEL 1290	1200mm	900mm	652mm
MODEL 1580	1500mm	800mm	652mm
MODEL 1590	1500mm	900mm	652mm
MODEL 1780	1700mm	800mm	702mm
MODEL 1790	1700mm	900mm	702mm

READ ONLY IF INSTALLING RAISED TRAY

RAISED TRAY VERSIONS AND FITTING WASTE

TRAY MUST BE LEVEL
IN ALL PLANES

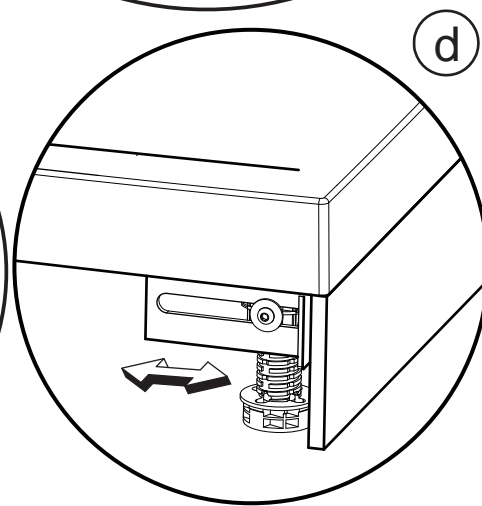
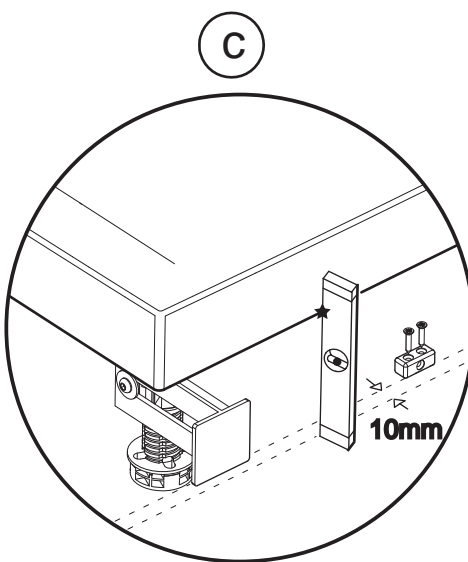
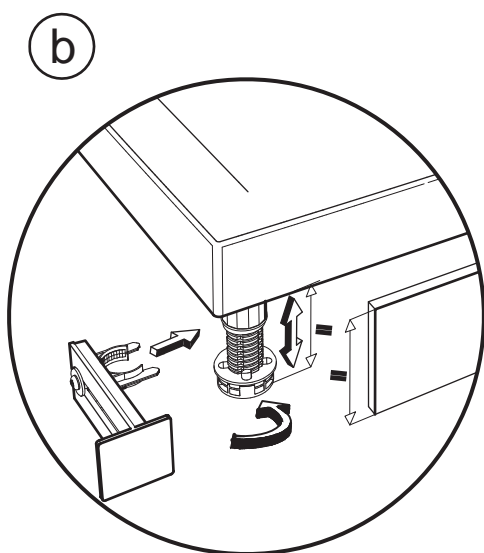
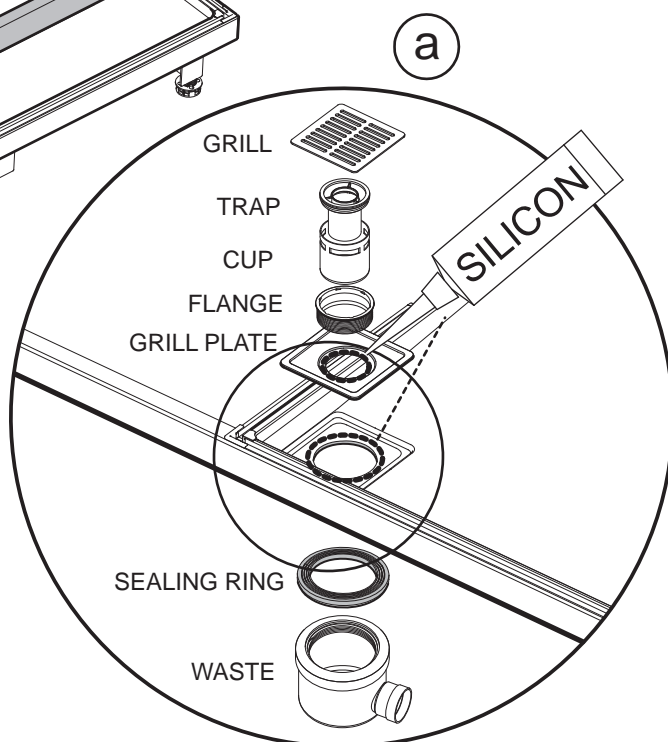
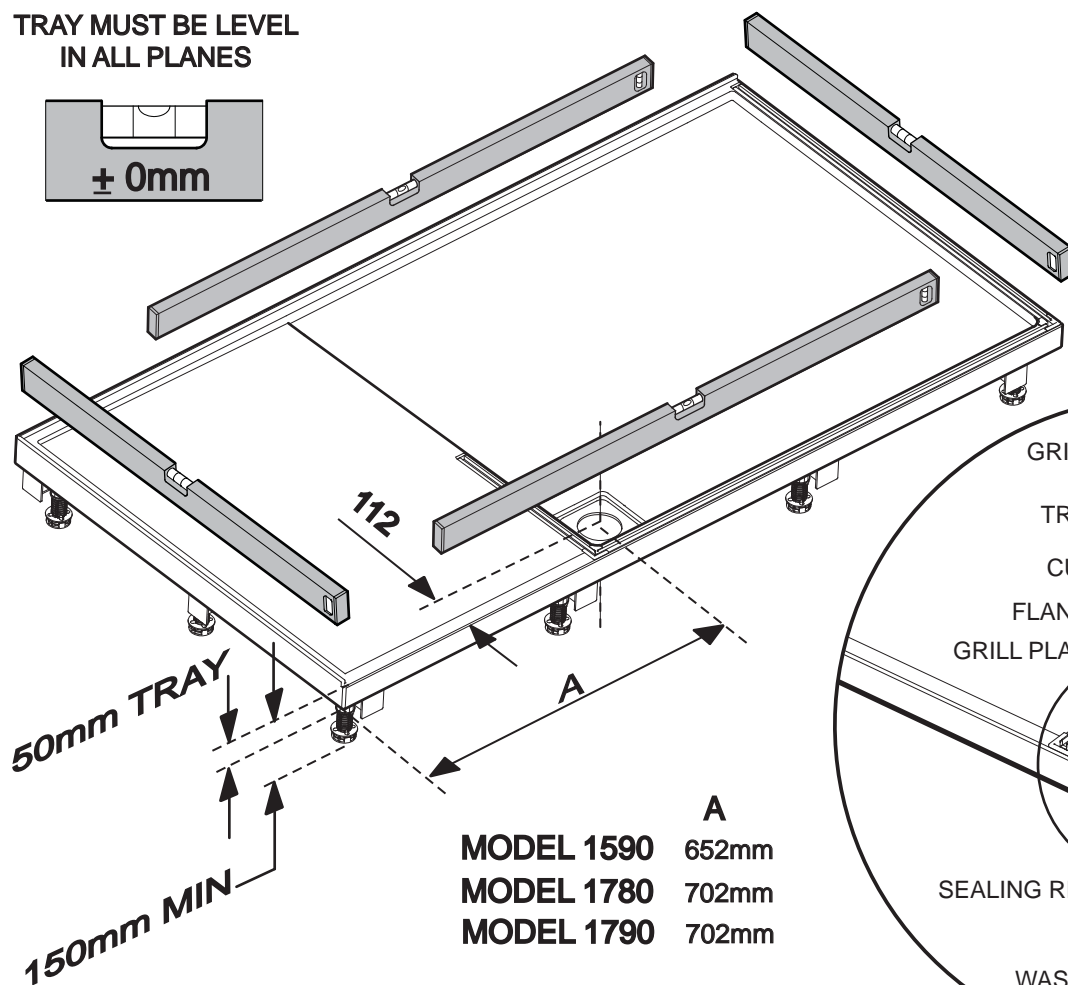
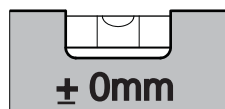

- a.** When fitting the shower waste apply a small continuous bead of silicon to the tray waste recess before fitting the square grill plate. Also apply a small continuous bead of silicon sealant in the circular recess of the square grill plate before fitting the shower waste and flange together. See installation instructions with shower waste.

Push fit the adjustable legs into cups on underside of the tray.

- b.** Adjust the height of the tray by winding the lower part of the leg to match the height of the front panel. Clip the panel brackets provided on to the legs that will be supporting the panel.

- c.** If required fit the support blocks supplied between legs.

- d.** Adjust the panel brackets so that the panel is flush with the front face of the tray.

The Matki panels are supplied extra long and these can be trimmed to size if needed using a fine toothed hacksaw. Align the velcro pads supplied with the panel brackets and fit the panel.

READ FOR ALL MODELS

PANEL FITTING INDEX

ILLUSTRATIONS SHOW LH MODELS

See relevant panel fitting instructions for the model.

NWSC

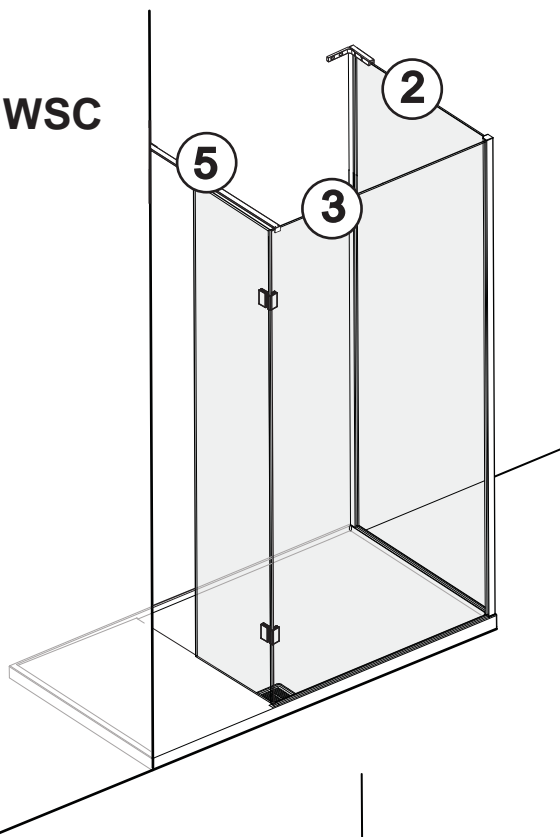

**NWSR
Recess
NWSF
Corner**

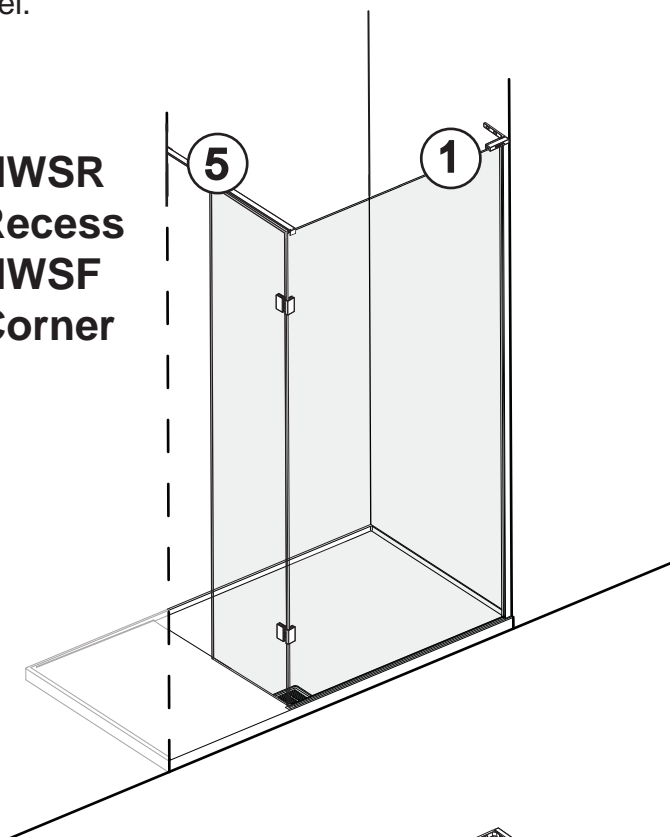

NWCC

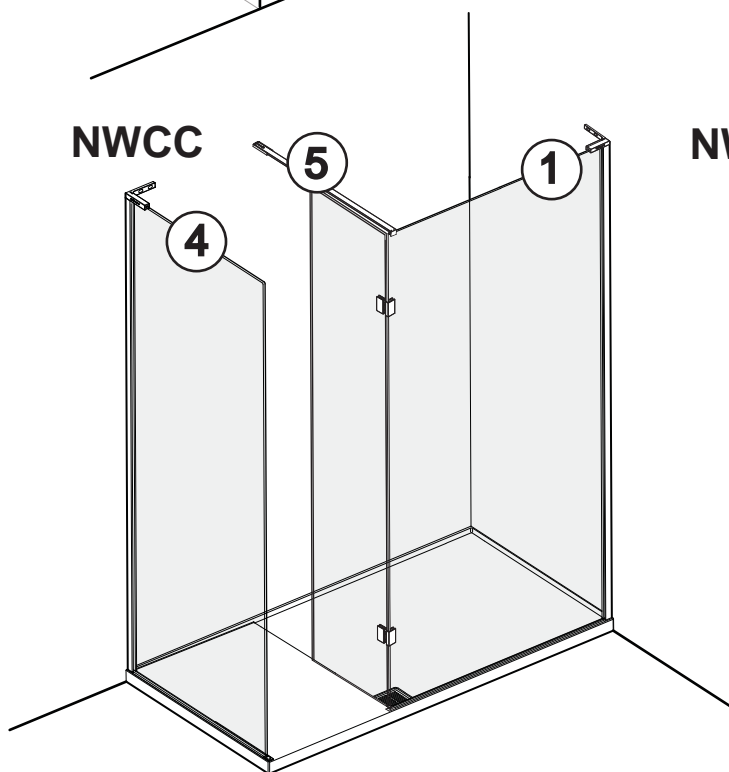

NWST

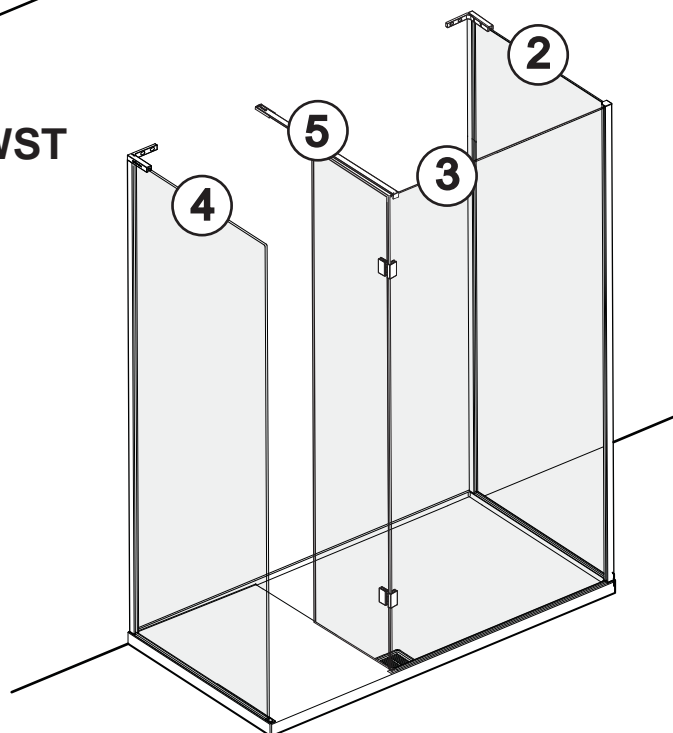

PANEL 1

FRONT PANEL

READ ONLY WHEN INSTALLING MODELS NWCC OR NWSR/NWSF

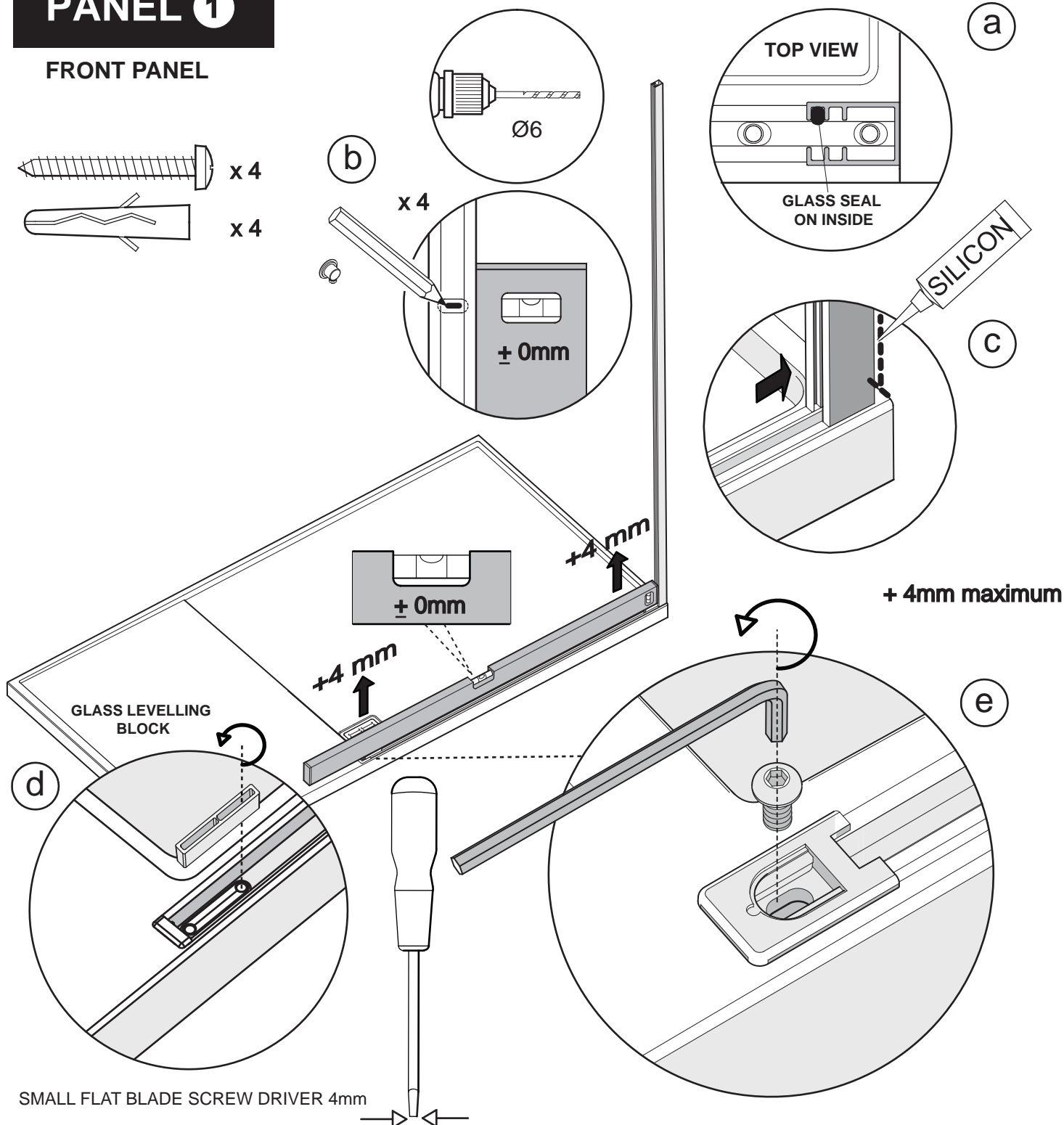

IMPORTANT: Remove the tray gasket end panel cap before fitting the front panel.

This stage is describing the fitting of the Front panel wall mount.

- Place the wall mount onto the top of the tray gasket with the wall mount glass seal on the inside. Align the opening in the wall mount with the opening in the tray glass gasket.
- Plumb the wall mount for upright and mark the fixing holes in the centre of the slots.
- Drill 4 x fixing holes in the wall and insert the wall plugs. Clean area and apply silicon sealant to the area behind the wall mount between the tray and tiles and 100mm up the wall, central to the width of the wall mount. Secure the wall mount using the No.8 x 32mm pan head screws, plumb the wall mount for upright do not overtighten the screws to allow for adjustment.
- The tray is fitted with adjustment screws in the base of the tray glass gaskets. Minor adjustments can be made to the level of the glass panel using these screws if the tray is not completely level before the glass panel is fitted. Place the clear glass levelling blocks into the tray gasket on top of the levelling adjustment screws, place a level between the blocks and check for level. Adjust the screws out in pairs at the required end of the level. Maximum upward adjustment of screws is 4mm. Maximum adjustment at one end will correct the glass for vertical by 8mm at the top. **DO NOT USE IF THE TRAY IS LEVEL.**
- Remove the tray gasket end panel cap before fitting the front panel.

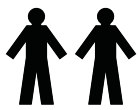

READ ONLY WHEN INSTALLING MODELS NWCC OR NWSR/NWSF

IMPORTANT: Panel is very heavy.

Two people required.

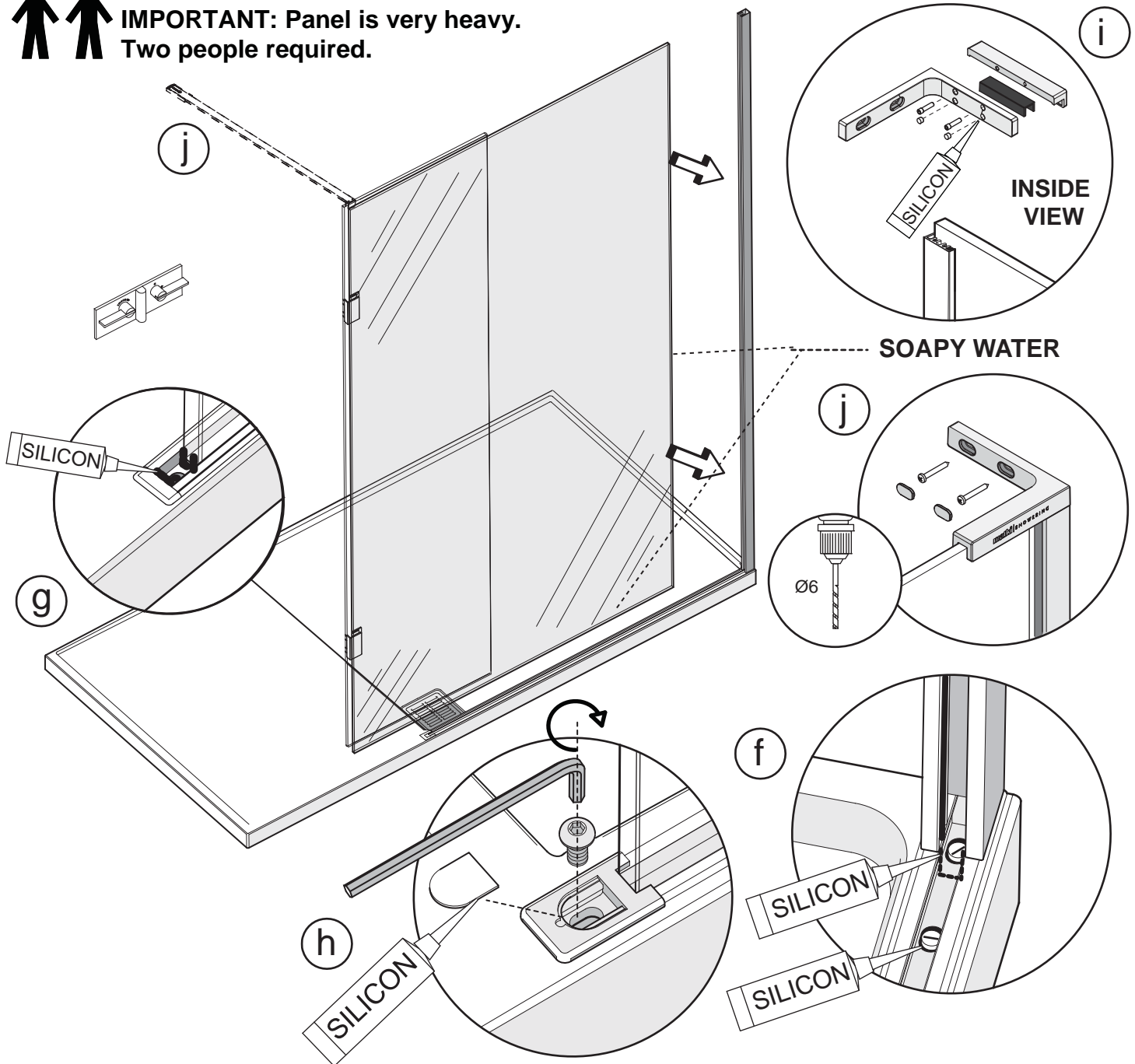

This stage is describing the fitting of the Front panel glass.

We recommend two people are available for this stage.

f. Before fitting the glass panel apply a small bead of silicon sealant around the tray gasket adjustment screws. Apply a small 'U' shaped bead of silicon in the base and sides of the tray gasket at the opening of the wall mount.

Important: The hinge front panel is very heavy, two people required. Lightly wet the vertical and bottom horizontal edge of the glass panel with soapy water and carefully lower the panel into the wall mount tray gasket. Push the top of the glass panel into the wall mount first followed by the bottom.

g. Apply a 'u' shaped bead of silicon sealant in the base and sides of the tray gasket at the end of the glass panel and end of the tray gasket.

h. Fit the panel end cap into the tray gasket and secure with the M6 button head screw, place a small spot of silicon sealant under the screw cover and fit.

i. Fitting of the Top bracket: Fit the rubber 'U' shaped gasket onto the top edge of the glass with the grooved face of the gasket facing outwards. Fit the wall bracket over the glass and onto the top of the wall mount.

j. Mark the centre of the slotted holes in the wall bracket onto the wall. Remove the wall bracket and drill and fix the wall plugs.

i. Refit the wall bracket. Clamp the bracket onto the glass by tightening the clamping screws on the inside of the bracket. Fit the clamping screw cover caps into the two unused holes on the inside of the wall bracket. Apply a small spot of silicon in the holes before fitting the caps.

j. Fix the bracket to the wall using the No.8 x 50 Pan head screws and fit the bracket screw cover cap

k. Fit panel brace bar included in deluge kit. (See separate instructions) Model: 1290, 1586, 1596, 1786, 1796.

Apply final silicon sealant to the wall mount when all stages of the installation are complete.

(See Silicon Sealant Stage)

PANEL 2

READ ONLY WHEN INSTALLING MODELS NWSC OR NWST

CORNER PANEL

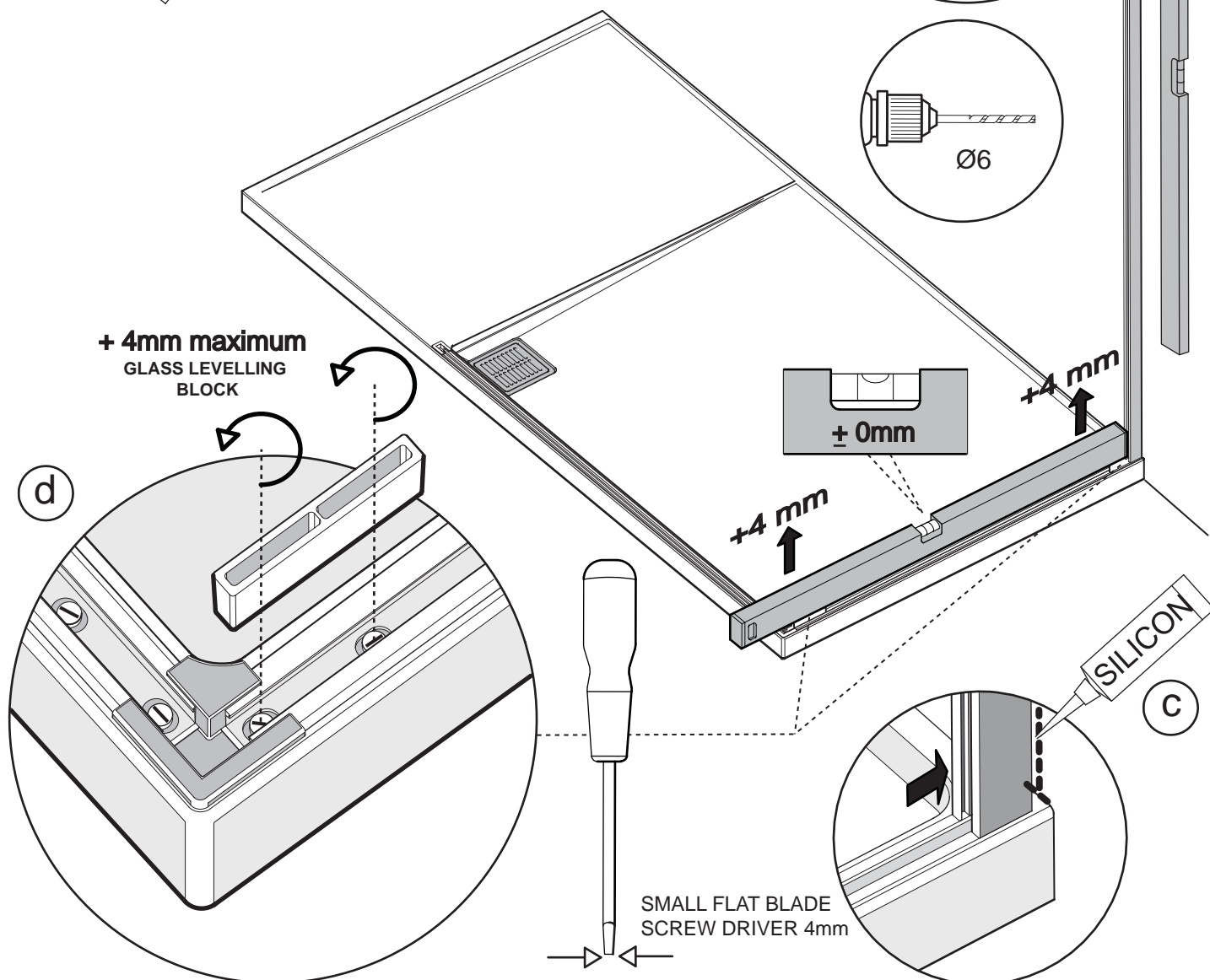
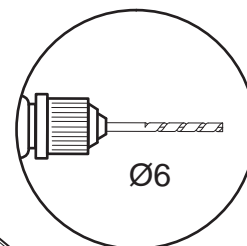
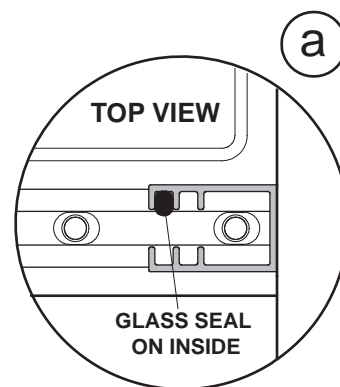
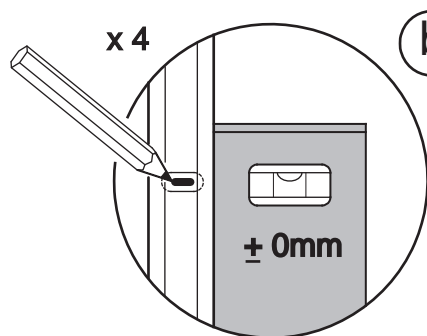
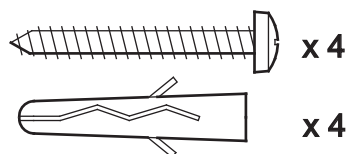

This stage is describing the fitting of the Corner panel wall mount.

- Place the wall mount onto the top of the tray gasket with the wall mount glass seal on the inside. Align the opening in the wall mount with the opening in the tray glass gasket.
- Plumb the wall mount for upright and mark the fixing holes in the centre of the slots.
- Drill 4 x fixing holes in the wall and insert the wall plugs. Clean area and apply silicon sealant to the area behind the wall mount between the tray and tiles and 100mm up the wall, central to the width of the wall mount. Secure the wall mount using the No.8 x 32mm pan head screws, plumb the wall mount for upright do not overtighten the screws to allow for adjustment.
- The tray is fitted with adjustment screws in the base of the tray glass gaskets. Minor adjustments can be made to the level of the glass panel using these screws if the tray is not completely level before the glass panel is fitted. Place the clear glass levelling blocks into the tray gasket on top of the levelling adjustment screws, place a level between the blocks and check for level. Adjust the screws out in pairs at the required end of the level. Maximum upward adjustment of screws is 4mm. Maximum adjustment at one end will correct the glass for vertical by 8mm at the top. **DO NOT USE IF THE TRAY IS LEVEL.**

READ ONLY WHEN INSTALLING MODELS NWSC OR NWST

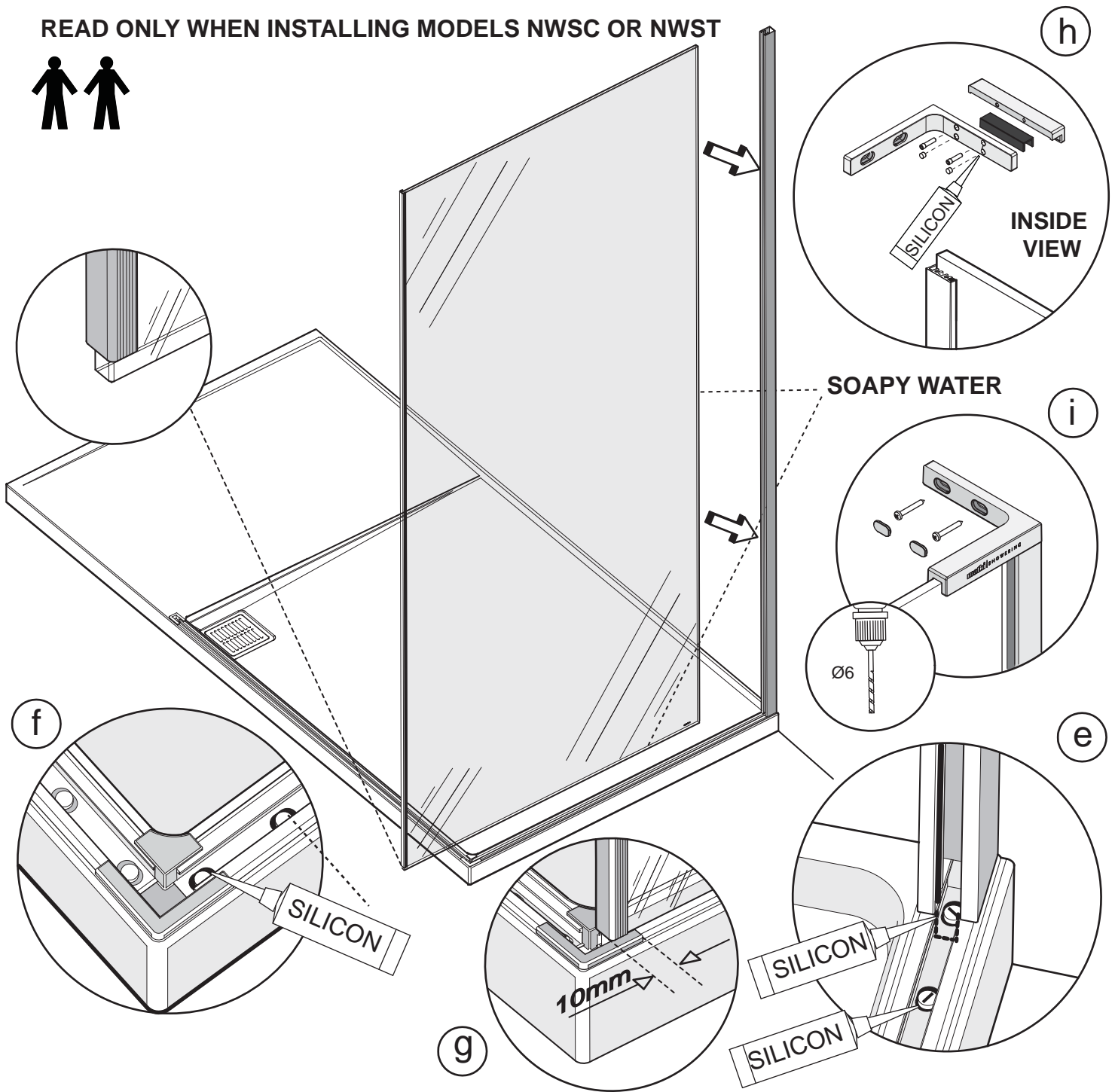

This stage is describing the fitting of the Corner panel glass.

We recommend two people are available for this stage.

- e.** Before fitting the glass panel apply a small bead of silicon sealant around the tray gasket adjustment screws.
Apply a small 'U' shaped bead of silicon in the base and sides of the tray gasket at the opening of the wall mount.
- f.** Apply a small bead of silicon sealant around the tray gasket adjustment screws at the chrome corner cap.
IMPORTANT: Fit the Corner panel with the vertical extrusion frame away from the wall. The bottom of the vertical frame stops short on the glass panel. Lightly wet the vertical and bottom horizontal edge of the glass panel with soapy water and gently lower the panel into the wall mount and tray gasket. Push the top of the panel into the wall mount first, followed by the bottom.
- g.** Adjust the glass panel so that the outside vertical edge is 10mm in from the outside edge of the chrome corner cap.
- h. Fitting of the Top bracket:** Fit the rubber 'U' shaped gasket onto the top edge of the glass with the grooved face of the gasket facing outwards. Fit the wall bracket over the glass and onto the top of the wall mount.
- i.** Mark the centre of the slotted holes in the wall bracket onto the wall. Remove the wall bracket and drill and fix the wall plugs.
- h.** Refit the wall bracket. Clamp the bracket onto the glass by tightening the clamping screws on the inside of the bracket. Fit the clamping screw cover caps into the two unused holes on the inside of the wall bracket. Apply a small spot of silicon in the holes before fitting the caps.
- i.** Fix the bracket to the wall using the No.8 x 50 Pan head screws and fit the bracket screw cover cap

Apply final silicon sealant to the wall mount when all stages of the installation are complete.

(See Silicon Sealant Stage)

PANEL 3

READ ONLY WHEN INSTALLING MODELS NWSC OR NWST
CORNER FRONT PANEL

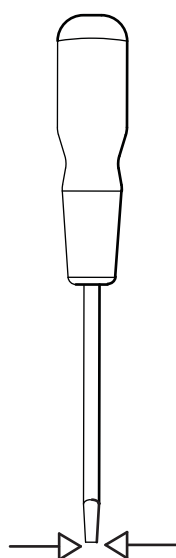
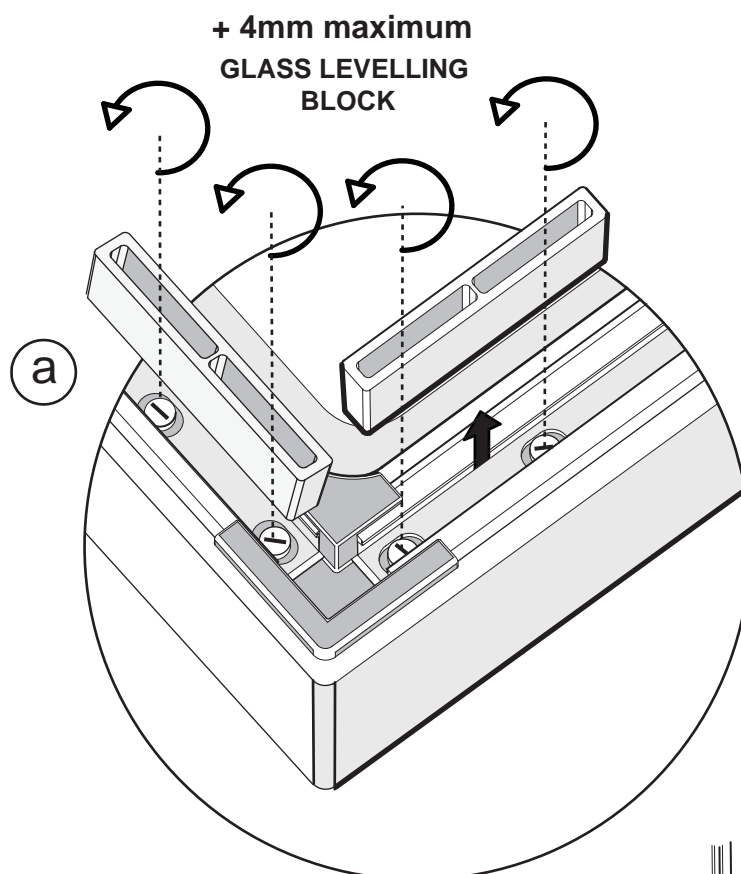
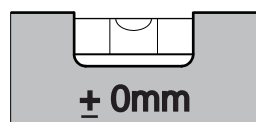

SMALL FLAT BLADE
SCREW DRIVER 4mm

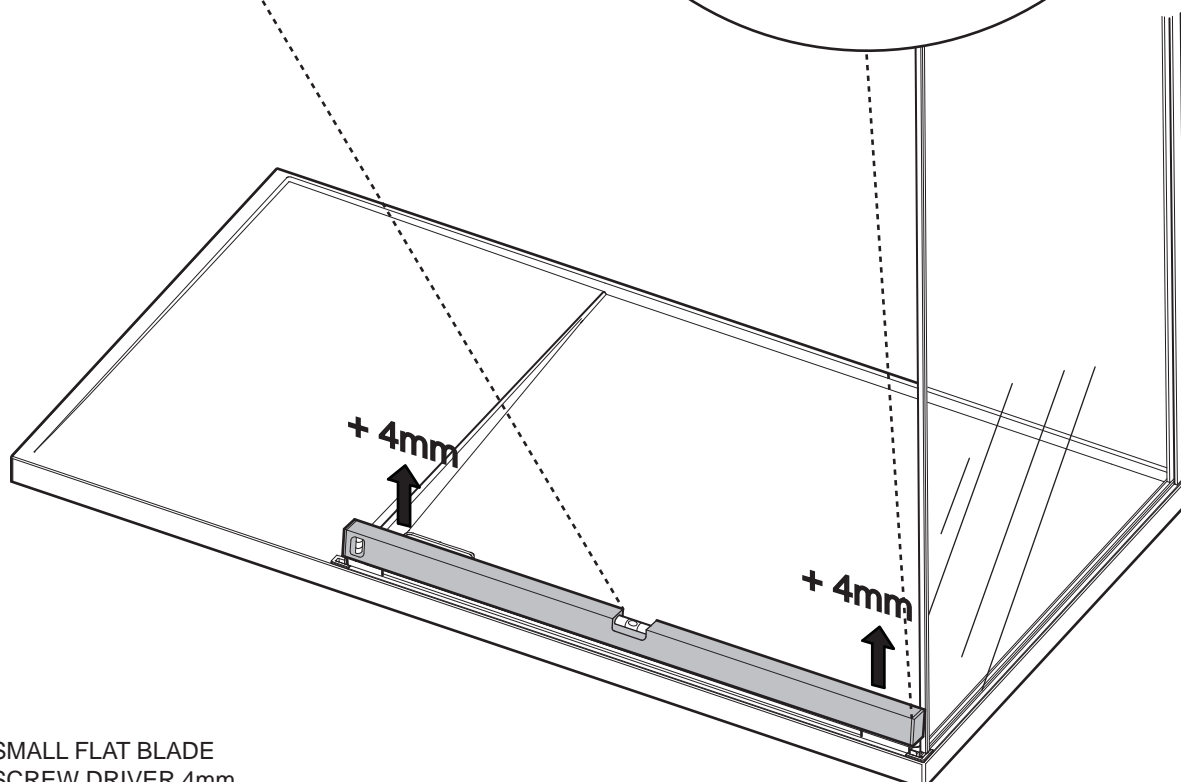

This stage is describing the fitting of the Corner Front panel.

a. The tray is fitted with adjustment screws in the base of the tray glass gaskets. Minor adjustments can be made to the level of the glass panel using these screws if the tray is not completely level before the glass panel is fitted. Place the clear glass levelling blocks into the tray gasket on top of the levelling adjustment screws, place a level between the blocks and check for level. Adjust the screws out in pairs at the require end of level. Maximum upward adjustment of screws 4mm. Maximum adjustment at one end will correct the glass for vertical by 8mm at the top. **DO NOT USE IF TRAY IS LEVEL**

**READ ONLY WHEN
INSTALLING MODELS
NWSC OR NWST
IMPORTANT: Panel
is very heavy. Two
people required.**



SOAPY WATER

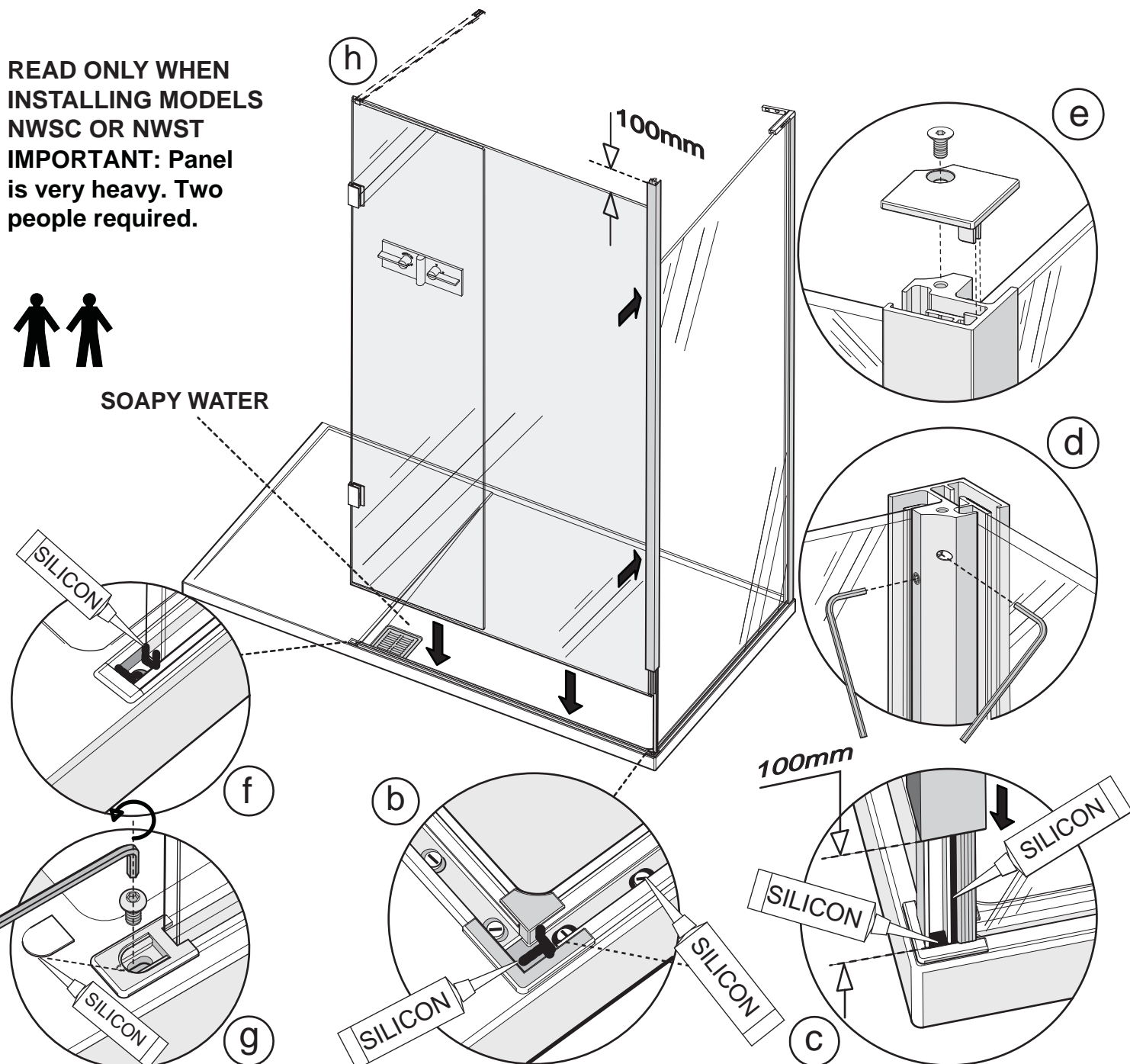

**This stage is describing the fitting of the Corner Front panel glass.
We recommend two people are available for this stage.**

IMPORTANT: Fit the corner front panel. Lightly wet the bottom horizontal edge of the glass panel with soapy water and gently lower the panel into tray gasket and onto the end of the corner panel. Ensure that the corner vertical frame is lifted 100mm above the top edge of the glass for applying silicon sealant under the corner frame. Adjust the glass panel so that the outside vertical edge is in the corner of the chrome corner cap.

- b.** Before fitting the glass panel apply a small bead of silicon sealant around the tray gasket adjustment screws. Apply a small 'U' shaped bead of silicon in the base and sides of the tray gasket at the joint between the tray gasket and chrome corner cap and a bead in the base of the corner cap.
- c.** Apply silicon sealant onto the ends of the glass panels in the corner cap and apply a vertical bead up 100mm between the end frames of the corner front panel and corner panel. Push the Corner frame down to the corner cap, allow any excess sealant on the joint between the corner cap and corner frame to cure before removal.
- d.** Adjust the corner frame for upright and lock into position with the locking screws on the inside top and bottom corner of the vertical frame.
- e.** Fit the corner vertical frame top cap and secure with the M4 x 8 csk screw.
- f.** Apply a 'u' shaped bead of silicon sealant in the base and sides of the tray gasket at the end of the glass panel and end of the tray gasket.
- g.** Fit the panel end cap into the tray gasket and secure with the M6 button head screw, place a small spot of silicon sealant under the screw cover and fit.
- h.** Fit panel brace bar included in deluge kit. (See separate instructions) Model: 1290, 1586, 1596, 1786, 1796.

HINGE PANEL

READ FOR ALL MODELS HINGE PANEL HORIZONTAL SEAL

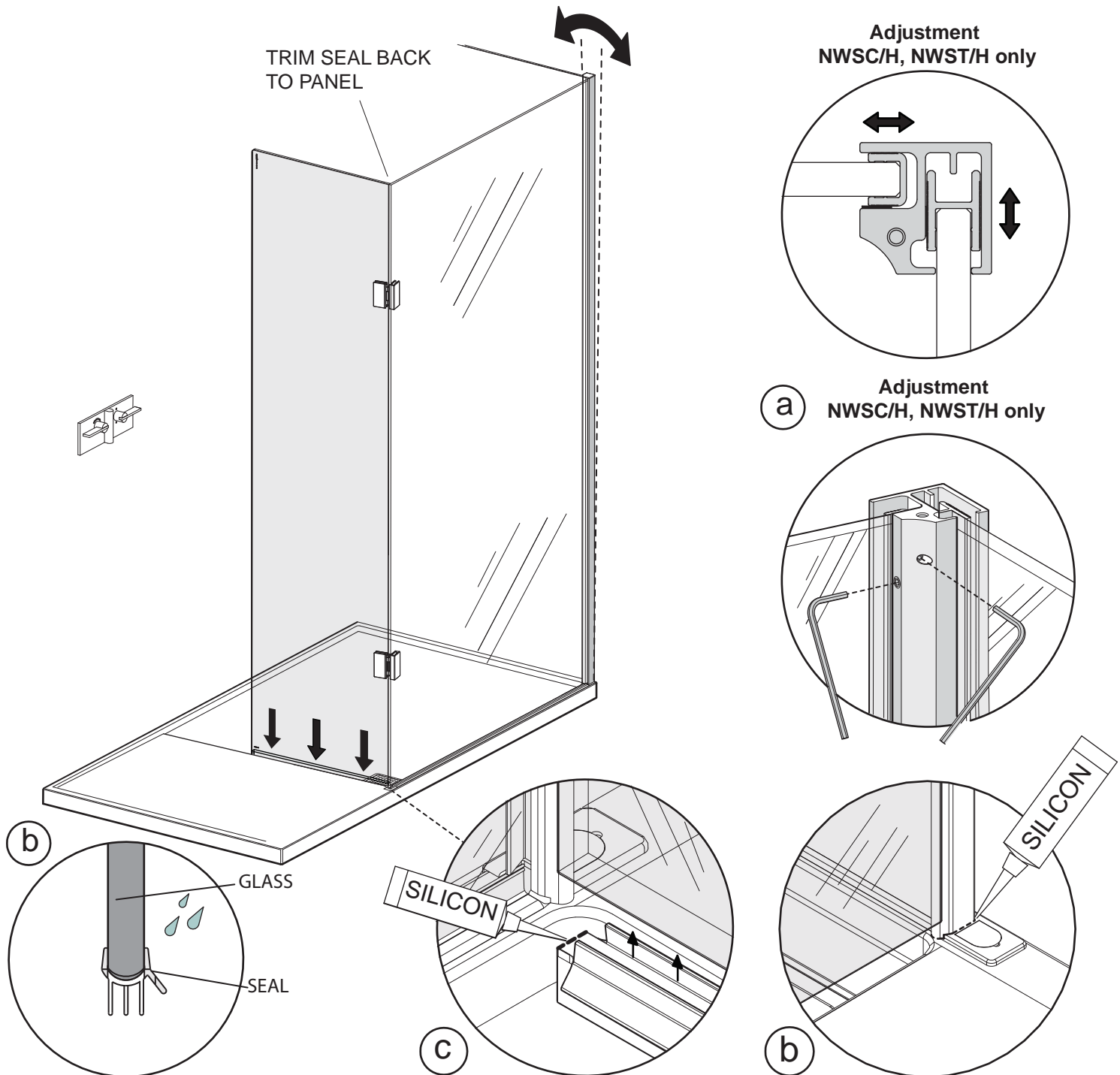

This stage is describing the adjustment of the Entrance panel before final fitting.

- a. For the NWSC/TBH and NWST/TBH models there is adjustment in the corner vertical frame which can be used to adjust the vertical line of the front panel. We recommend that any adjustment should be made once the overhead deluge and riser rail is fitted.
- b. Fit the Hinge panel horizontal seal to the bottom edge of the panel with the deflector edge on the inside of the hinge glass panel. Before fitting the seal place a small spot of silicon sealant at the hinge end of the seal between the bottom edge of the glass panel and seal. Push fit the seal onto the glass so that the end of the seal is flush with the end of the hinge panel glass where it meets the vertical hinge seal.
- c. Apply silicon sealant where the hinge vertical seal meets the panel end cap and shower tray.

PANEL 4

READ ONLY WHEN INSTALLING MODELS NWCC OR NWST ENTRANCE SIDE PANEL

TOP THREADS IN SCREW PORTS

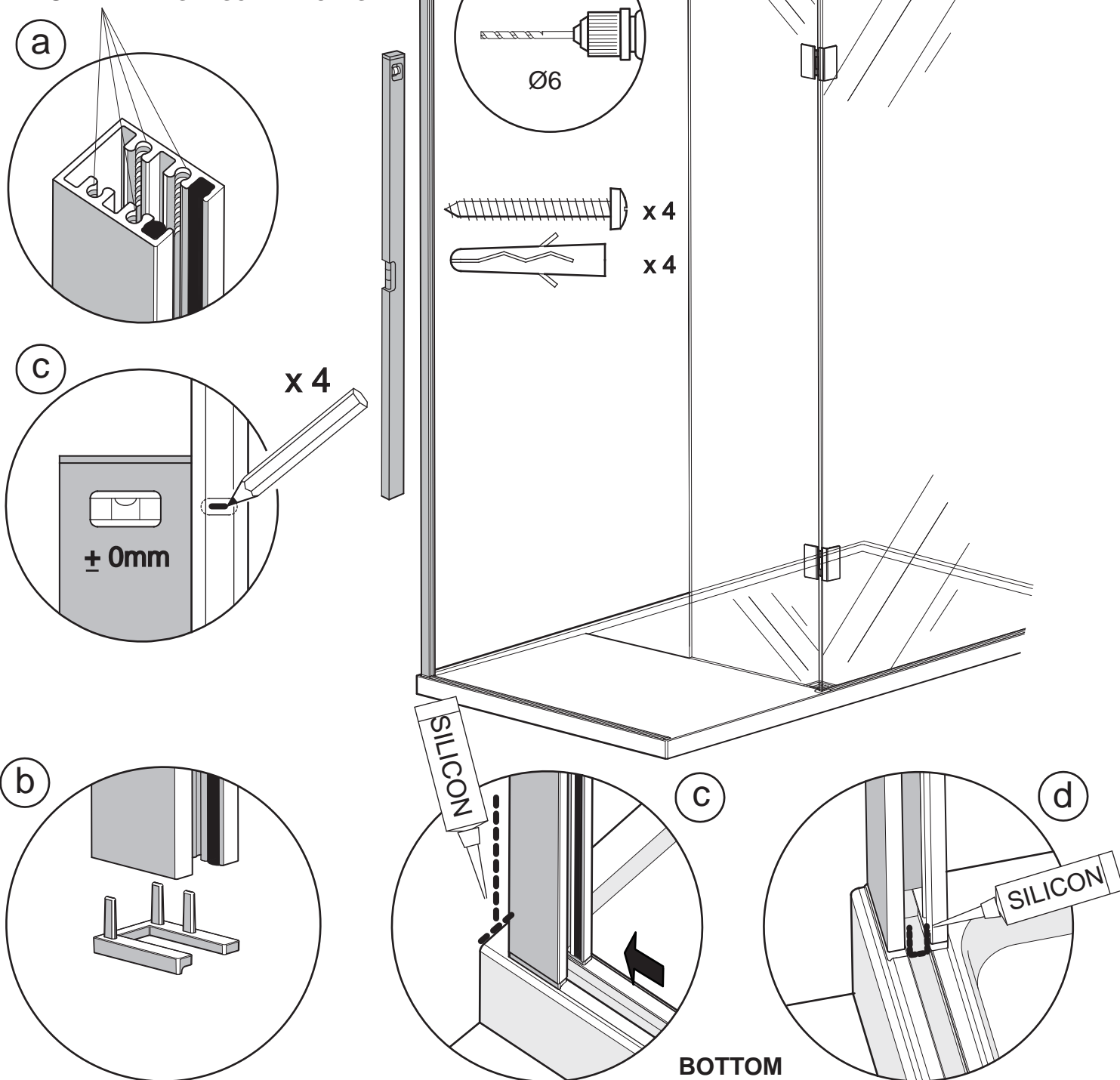

This stage is describing the fitting of the Entrance Side panel wall mount.

- The Wall mount has a top and bottom, the top has the threaded holes for the fitting of the top wall bracket.
- Before placing the wall mount fit the bottom cap with the thicker edge on the outside. Place the wall mount onto the top of the tray glass gasket. Align the opening in the wall mount with the opening in the tray glass gasket.
- Plumb the wall mount for upright and mark the fixing holes in the centre of the slots. Drill 4 x fixing holes in the wall and insert the wall plugs. Clean area and apply silicon sealant to the area behind the wall mount between the tray and tiles and 100mm up the wall, central to the width of the wall mount. Secure the wall mount using the No.8 x 32mm pan head screws, plumb the wall mount for upright do not overtighten the screws to allow for adjustment.
- Before fitting the Entrance Side panel glass apply a small 'U' shaped bead of silicon in the base and sides of the tray gasket at the opening of the wall mount.

READ ONLY WHEN INSTALLING MODELS NWCC OR NWST

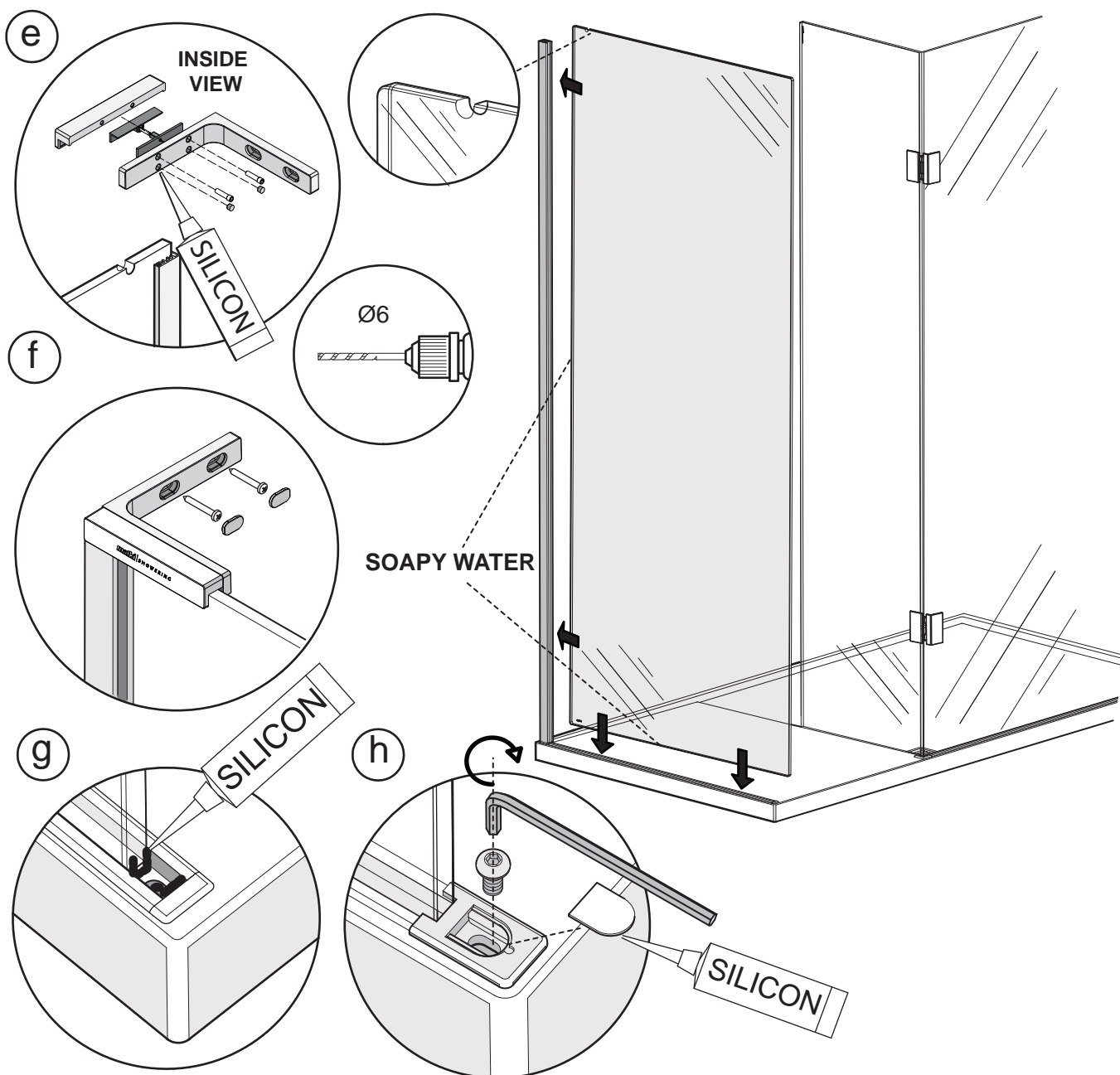

This stage is describing the fitting of the Entrance Side Panel.

IMPORTANT - Before fitting the entrance side panel, lightly wet the vertical and horizontal edges of the glass panel with soapy water and gently lower the panel into the wall mount and tray gasket. Push the top of the panel into the wall mount first, followed by the bottom.

- e.** Fit the two piece hard plastic 'u' shaped gasket into the cut out in the top edge of the glass with the grooved face of the gasket facing outwards. Fit the wall bracket over the glass and onto the top of the wall mount. d. Mark the centre of the slotted holes in the wall bracket onto the wall, remove the wall bracket and drill and fix the wall plugs. Refit the wall bracket. Clamp the bracket to the glass by tightening the clamping screws on the inside of the bracket. Fit the clamping screw cover caps into the two unused holes on the inside of the wall bracket. Apply a small spot of silicon in the holes before fitting the caps.
- f.** Fix the bracket to the wall using the No.8 x 50 pan head screws and fit the bracket screw cover caps.
- g.** Apply a 'U' shaped bead of silicon sealant in the base and sides of the tray gasket at the end of the glass panel and end of the gasket.
- h.** Fit the Entrance side panel cap into the tray gasket and secure with the M6 button head screw, place a small spot of silicon sealant under the screw cover and fit.

**Apply final silicon sealant to the wall mount when all stages of the installation are complete.
(See Silicon Sealant Stage)**

PANEL 5

READ FOR ALL MODELS
ILLUSTRATIONS SHOW FITTING
THE BRACE BAR

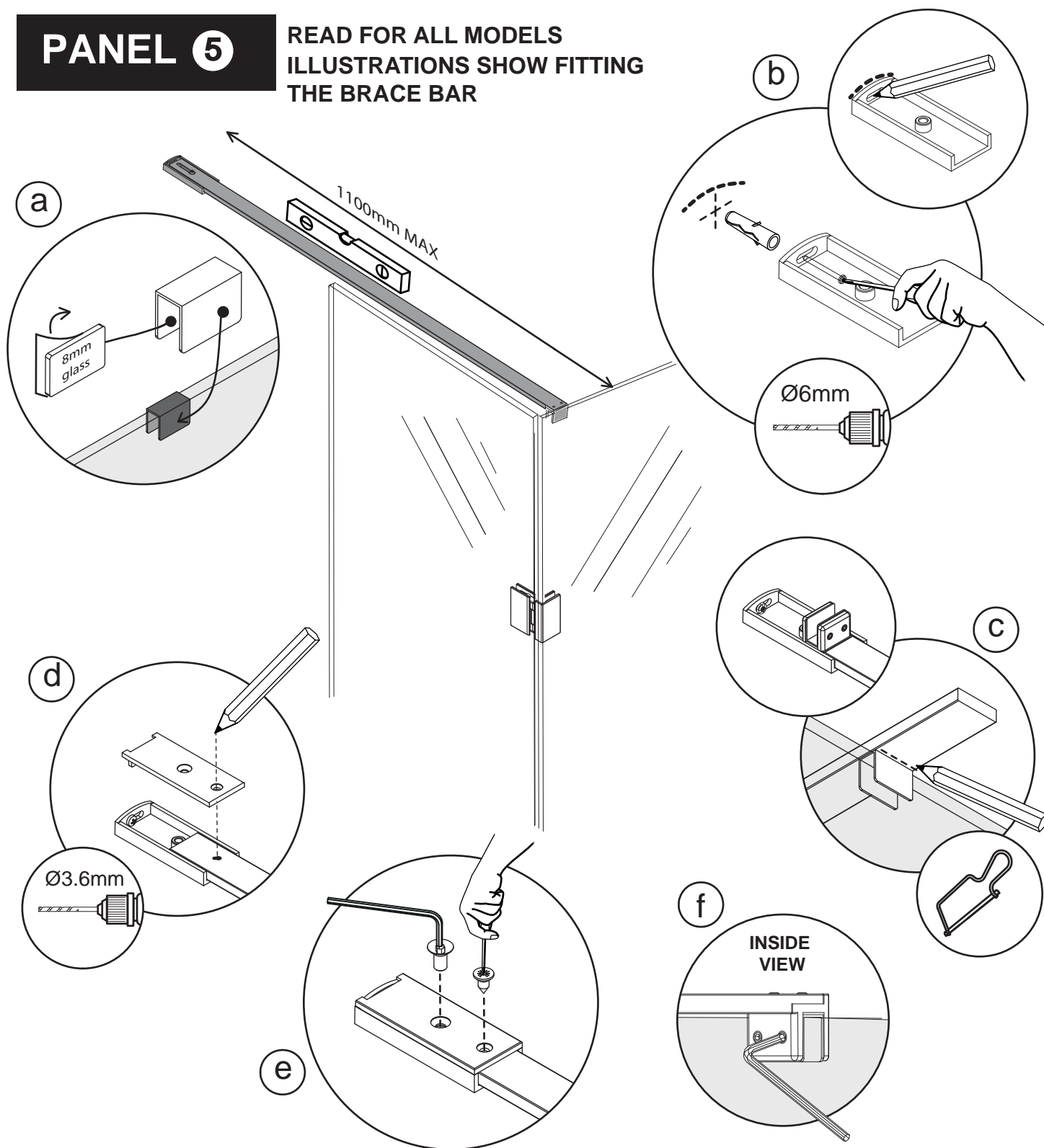

This stage is describing the fitting of the Brace Bar.

- a.** Fit the glass gasket over the top of the panel close to the end of the panel. Add the extra glass packer for 8mm glass, before fitting, if required. Rest the Brace bar on top of the glass bracket, with the end in the wall bracket as shown in step **d**. Level the brace bar.
- b.** Mark the position of the wall bracket along the top and also the screw slot. Drill a Ø6mm fixing hole and fit the rawl plug. Secure the wall bracket in place using the No.8 x 51mm pan head screw.
- c.** Place the brace bar on the bracket with the glass clamp end upright, pushed up against the raised threaded boss. The end may overhang the glass panel, mark underneath as shown. Remove and cut to length, taking care not to damage the chrome finish.
- d.** Place the glass clamp over the glass gasket on the panel. Resting the end of the brace bar in the wall bracket, place the cover cap over and mark the hole. Drill a Ø3.6mm fixing hole.
- e.** Secure the brace bar into the wall bracket using the No.8 x 10mm Countersunk Screw
- f.** Tighten the grub screws under the glass clamp to secure the brace in place.

SILICON SEALANT

READ FOR ALL MODELS
ILLUSTRATIONS SHOW LH MODELS

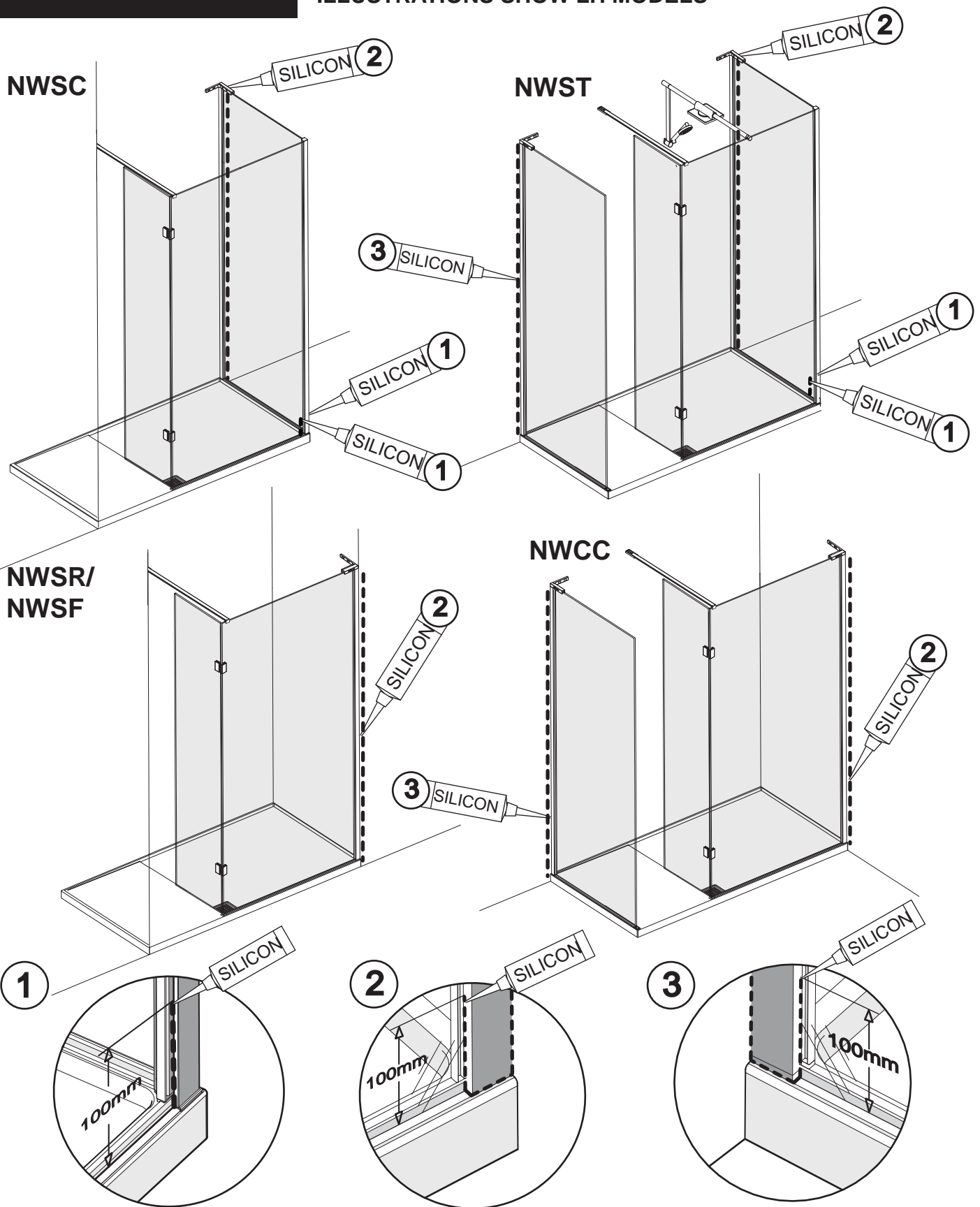

1.NWSC and NWST.

Apply a thin bead of silicon at the bottom of the corner extrusion 100mm up the joint between the front and corner glass panels and the corner extrusion.

2&3.NWCC, NWSC, NWSR, NWST, NWSF.

Apply a thin bead of silicon along the bottom edge of both the wall mounts where they meet the tray and 100mm up the joint between the glass panel and wall mount. Apply silicon all the way up the outside of the wall mount extrusion between the wall mount and the tiles. Masking tape can be used to achieve a tidy edge to the sealant. Remove the masking tape immediately and allow the silicon to cure for 24 - 48 hours before using the shower.

NWST/H PARTS LIST

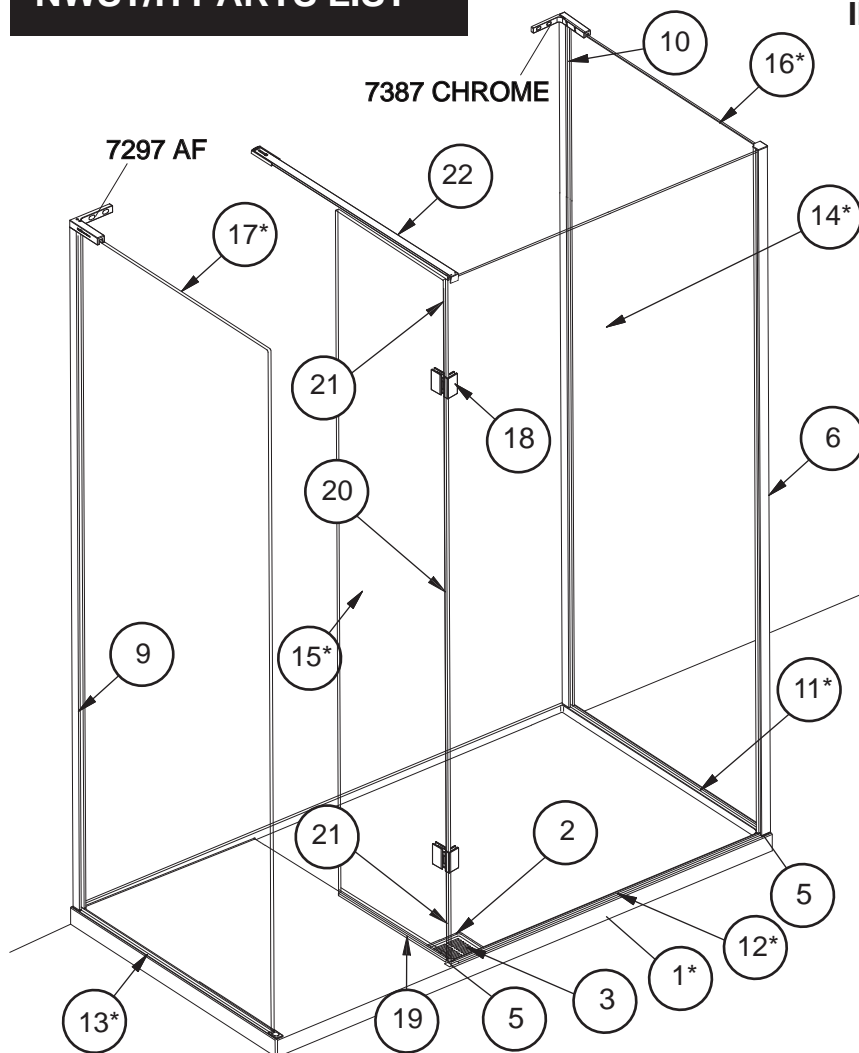
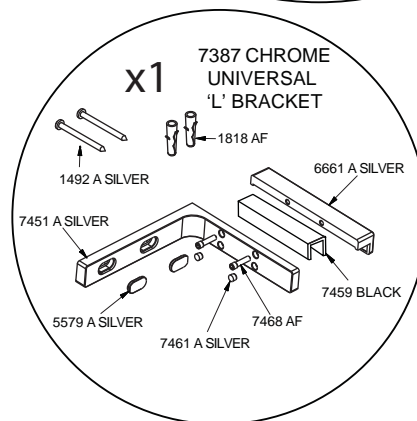
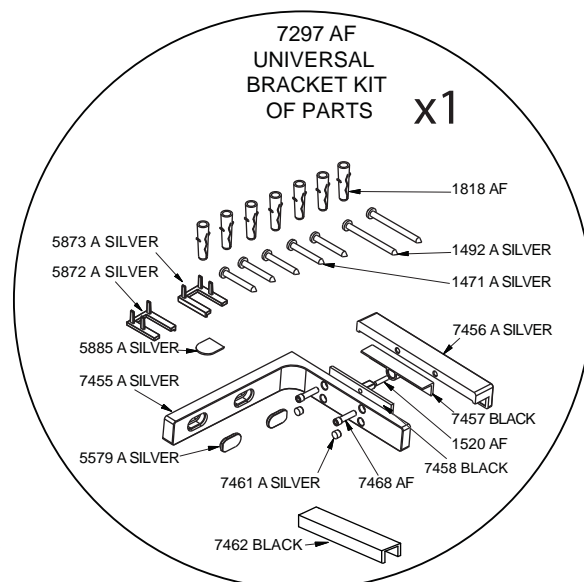

ILLUSTRATION SHOWS LH MODEL



PARTS LIST

ITEM	DESCRIPTION	PART NUMBER	QTY	LENGTH
* 1	NWST/H 1700 X 900 LH / RH		1	
	NWST/H 1700 X 800 LH / RH		1	
	NWST/H 1500 X 900 LH / RH		1	
	NWST/H 1200 X 900 LH / RH		1	
			1	
2	SQUARE WASTE FLANGE	5861 A SILVER	1	
3	SQUARE TRAY GRILL	7491 A SILVER	1	
4	FAST FLOW WASTE WITH 70mm FLANGE	RR0000402	1	
5	CORNER TRAY CAP	5882 A SILVER	2	
6	CORNER EXTRUSION	5790 A SILVER	1	1997mm
7	M4 X 8 SOCKET SET SCREW	1360 A SILVER	2	
8	M4 X 14 SOCKET SET SCREW	1279 A SILVER	2	
9	END PANEL MOUNT	5794 A SILVER	1	1979mm
10	WALL MOUNT	5786 A SILVER	1	1982mm
* 11	CORNER PANEL TRAY GASKET			
	MODEL 800	2329 WHITE	1	751mm
	MODEL 900	2330 WHITE	1	851mm
* 12	FRONT PANEL TRAY GASKET			
	MODEL 1500	2367 WHITE	1	931mm
	MODEL 1700	2368 WHITE	1	1082mm
* 13	ENTRANCE SIDE PANEL TRAY GASKET			
	MODEL 800	2325 WHITE	1	759mm
	MODEL 900	2326 WHITE	1	859mm
* 14	CORNER FRONT PANEL GLASS			
	MODEL 1200	8191 M CLEAR/PLAIN	1	608mm
	MODEL 1500	8184 M CLEAR/PLAIN	1	908mm
	MODEL 1700	8185 M CLEAR/PLAIN	1	1058mm
* 15	HINGE PANEL GLASS			
		7678 M CLEAR/PLAIN	1	400mm
		8187 M CLEAR/PLAIN	1	450mm
		8188 M CLEAR/PLAIN	1	500mm
* 16	CORNER PANEL GLASS			
	MODEL 800	7973 M CLEAR/PLAIN	1	2000 x 747mm
	MODEL 900	7972 M CLEAR/PLAIN	1	2000 x 847mm
* 17	ENTRANCE SIDE PANEL GLASS			
	MODEL 800	7979 M CLEAR/PLAIN	1	2000 x 740mm
	MODEL 900	7978 M CLEAR/PLAIN	1	2000 x 840mm
18	NWH OPENING HINGE	7295 AF	2	
* 19	NWH HORIZONTAL SEAL 1500	2372 CLEAR	1	445mm
	NWH HORIZONTAL SEAL 1700	2373 CLEAR	1	495mm
20	BOUTIQUE CENTRE VERTICAL SEAL	2382 CLEAR	1	1193mm
21	BOUTIQUE VERTICAL SEAL	2383 CLEAR	2	376mm
22	BRACE BAR	7324 AF	1	

BOUTIQUE NW-H PARTS KIT 7296 AF.

ITEM	DESCRIPTION	PART No.	QTY
1	WALL MOUNT TOP CAP	5869 A SILVER	1
2	CORNER EXTRUSION TOP CAP LH	5870 A SILVER	1
3	TRAY CLAMP COVER CAP	5885 A SILVER	1
4	CORNER EXTRUSION TOP CAP RH	5868 A SILVER	1
5	GLASS LEVELING BLOCK	5887 CLEAR	3
6	M4 x 8 CSK SOCKET HEAD SCREW	1499 A SILVER	1
7	WALL PLUG	1818 AF	5
8	No.8 x 32 PAN HEAD SELF TAPPING SCREW	1471 A SILVER	5
9	INSTALLATION INSTRUCTIONS	0964 AF	1
10	GARANTEE BOOKLET	1061 AF	1

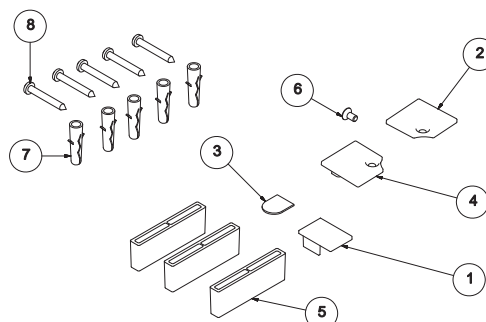

* ITEM VARIES DEPENDING ON MODEL

NWSC/H PARTS LIST

ILLUSTRATION SHOWS LH MODEL

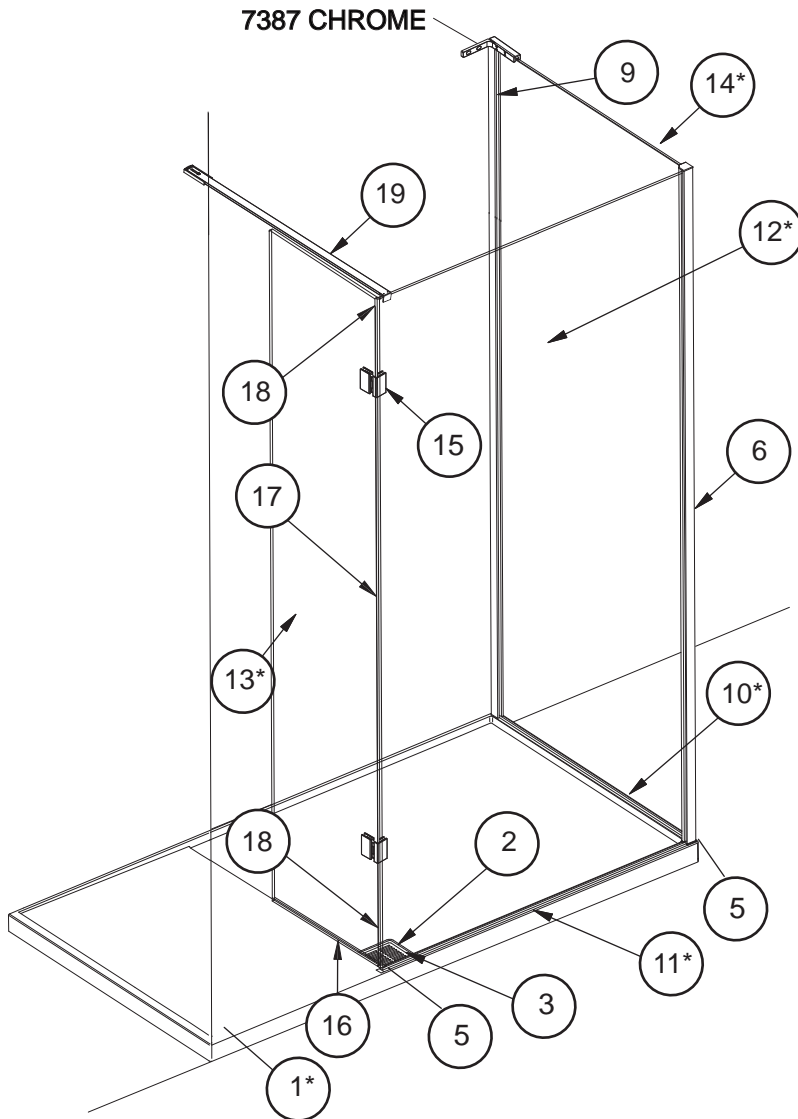

BOUTIQUE NW-H PARTS KIT 7296 AF.

PARTS LIST				
ITEM	DESCRIPTION	PART NUMBER	QTY	LENGTH
* 1	NWSC/H 1700 X 900 LH / RH		1	
	NWSC/H 1700 X 800 LH / RH		1	
	NWSC/H 1500 X 900 LH / RH		1	
	NWSC/H 1200 X 900 LH / RH		1	
2	SQUARE WASTE FLANGE	5861 A SILVER	1	
3	SQUARE TRAY GRILL	7491 A SILVER		
4	FAST FLOW WASTE WITH 70mm FLANGE	RR0000402	1	
5	CORNER TRAY CAP	5882 A SILVER	2	
6	CORNER EXTRUSION	5790 A SILVER	1	1997mm
7	M4 X 8 SOCKET SET SCREW	1360 A SILVER	2	
8	M4 X 14 SOCKET SET SCREW	1279 A SILVER	2	
9	WALL MOUNT	5786 A SILVER	1	1982mm
* 10	CORNER PANEL TRAY GASKET			
	MODEL 800	2329 WHITE	1	751mm
	MODEL 900	2330 WHITE	1	851mm
* 11	FRONT PANEL TRAY GASKET			
	MODEL 1500	2367 WHITE	1	931mm
	MODEL 1700	2368 WHITE	1	1082mm
* 12	CORNER FRONT PANEL GLASS			
	MODEL 1200	8191 M CLEAR/PLAIN		608mm
	MODEL 1500	8184 M CLEAR/PLAIN		908mm
	MODEL 1700	8185 M CLEAR/PLAIN	1	1058mm
* 13	HINGE PANEL GLASS			
		7678 M CLEAR/PLAIN	1	400mm
		8187 M CLEAR/PLAIN	1	450mm
		8188 M CLEAR/PLAIN	1	500mm
* 14	CORNER PANEL GLASS			
	MODEL 800	7973 M CLEAR/PLAIN	1	2000 x 747mm
	MODEL 900	7972 M CLEAR/PLAIN	1	2000 x 847mm
15	NWH OPENING HINGE	7295 AF	2	
* 16	NWH HORIZONTAL SEAL 1500	2372 CLEAR	1	445mm
	NWH HORIZONTAL SEAL 1700	2373 CLEAR	1	495mm
17	BOUTIQUE CENTRE VERTICAL SEAL	2382 CLEAR	1	1196mm
18	BOUTIQUE VERTICAL SEAL	2383 CLEAR	2	376mm
19	BRACE BAR	7324 AF	1	

ITEM	DESCRIPTION	PART No.	QTY
1	WALL MOUNT TOP CAP	5869 A SILVER	1
2	CORNER EXTRUSION TOP CAP LH	5870 A SILVER	1
3	TRAY CLAMP COVER CAP	5885 A SILVER	1
4	CORNER EXTRUSION TOP CAP RH	5868 A SILVER	1
5	GLASS LEVELING BLOCK	5887 CLEAR	3
6	M4 x 8 CSK SOCKET HEAD SCREW	1499 A SILVER	1
7	WALL PLUG	1818 AF	5
8	No.8 x 32 PAN HEAD SELF TAPPING SCREW	1471 A SILVER	5
9	INSTALLATION INSTRUCTIONS	0964 AF	1
10	GUARANTEE BOOKLET	1061 AF	1

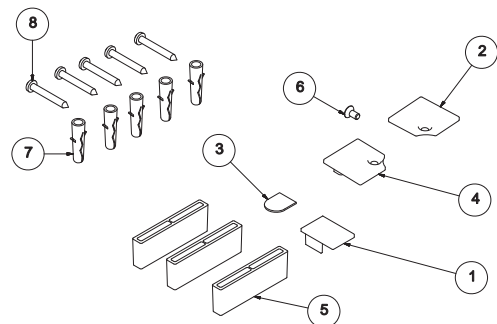

* ITEM VARIES DEPENDING ON MODEL

NWSR/H, NWSF/H PARTS LIST

ILLUSTRATION SHOWS LH MODEL

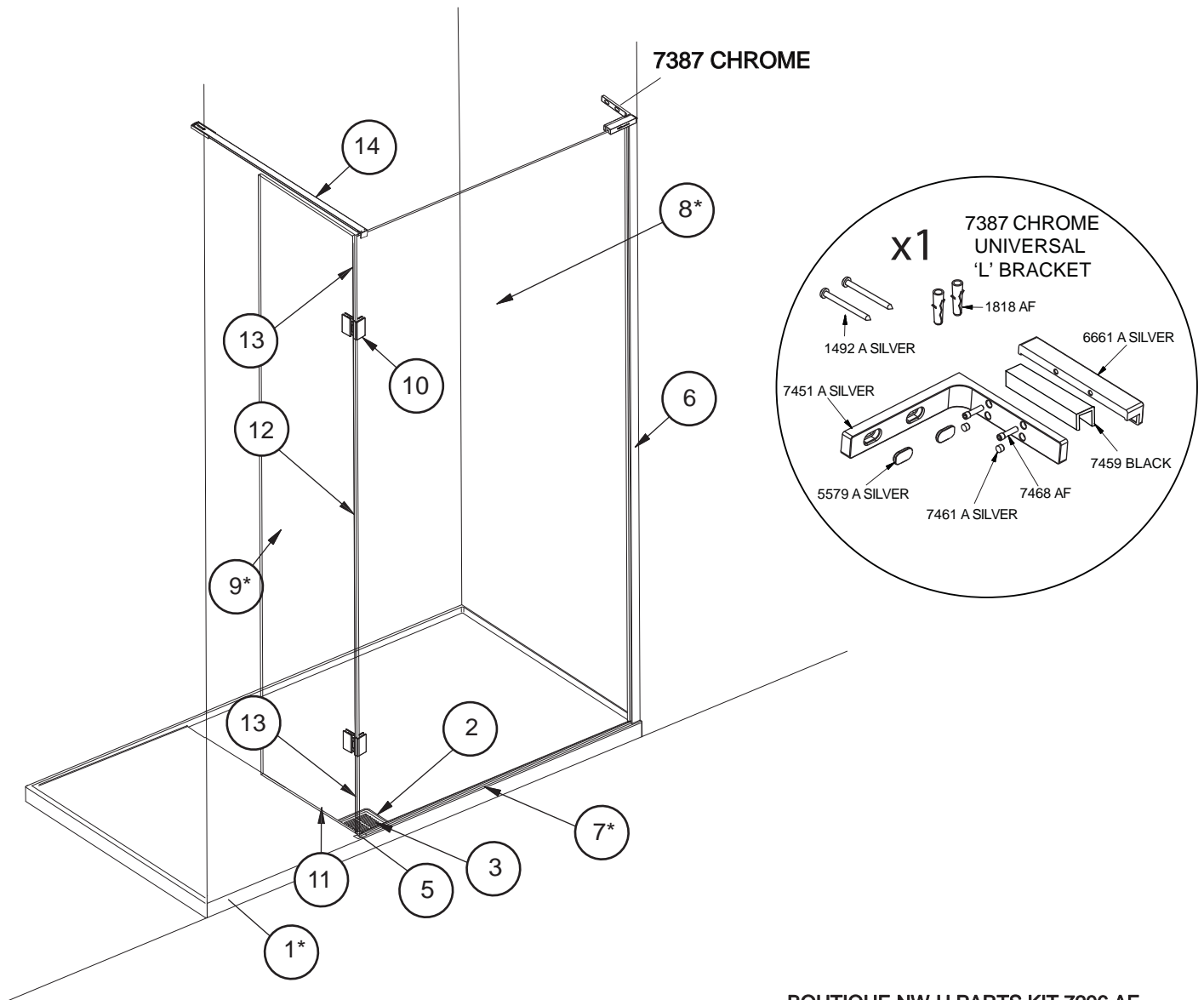

BOUTIQUE NW-H PARTS KIT 7296 AF.

PARTS LIST				
ITEM	DESCRIPTION	PART NUMBER	QTY	LENGTH
* 1	NWSR/H 1700 X 900 LH / RH		1	
	NWSR/H 1700 X 800 LH / RH		1	
	NWSR/H 1500 X 900 LH / RH		1	
	NWSR/H 1200 X 900 LH / RH		1	
			1	
2	SQUARE WASTE FLANGE	5861 A SILVER	1	
3	SQUARE TRAY GRILL	7491 A SILVER	1	
4	FAST FLOW WASTE WITH 70mm FLANGE	RR0000402	1	
5	CORNER TRAY CAP	5882 A SILVER	1	
6	WALL MOUNT	5786 A SILVER	1	1982mm
* 7	FRONT PANEL TRAY GASKET			
	MODEL 1500	2369 WHITE	1	935mm
	MODEL 1700	2370 WHITE	1	1085mm
* 8	FRONT PANEL GLASS			
	MODEL 1200	8191 M CLEAR/PLAIN	1	608mm
	MODEL 1500	8184 M CLEAR/PLAIN	1	908mm
	MODEL 1700	8185 M CLEAR/PLAIN	1	1058mm
* 9	HINGE PANEL GLASS			
		7678 M CLEAR/PLAIN	1	400mm
		8187 M CLEAR/PLAIN	1	450mm
		8188 M CLEAR/PLAIN	1	500mm
10	NWH OPENING HINGE	7295 AF	2	
* 11	NWH HORIZONTAL SEAL 1500	2372 CLEAR	1	445mm
	NWH HORIZONTAL SEAL 1700	2373 CLEAR	1	495mm
12	BOUTIQUE CENTRE VERTICAL SEAL	2382 CLEAR	1	1196mm
13	BOUTIQUE VERTICAL SEAL	2383 CLEAR	2	376mm
14	BRACE BAR	7324 AF	1	

ITEM	DESCRIPTION	PART No.	QTY
1	WALL MOUNT TOP CAP	5869 A SILVER	1
2	CORNER EXTRUSION TOP CAP LH	5870 A SILVER	1
3	TRAY CLAMP COVER CAP	5885 A SILVER	1
4	CORNER EXTRUSION TOP CAP RH	5886 A SILVER	1
5	GLASS LEVELING BLOCK	5887 CLEAR	3
6	M4 x 8 CSK SOCKET HEAD SCREW	1499 A SILVER	1
7	WALL PLUG	1818 AF	5
8	No.8 x 32 PAN HEAD SELF TAPPING SCREW	1471 A SILVER	5
9	INSTALLATION INSTRUCTIONS	0964 AF	1
10	GUARANTEE BOOKLET	1061 AF	1

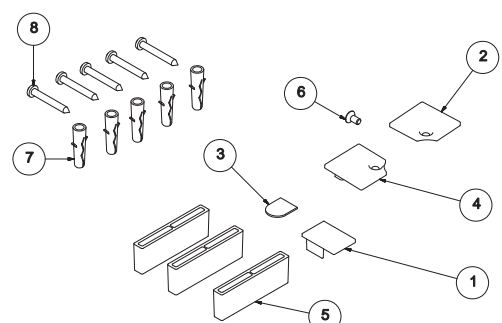

* ITEM VARIES DEPENDING ON MODEL

NWCC/H PARTS LIST

ILLUSTRATION SHOWS LH MODEL

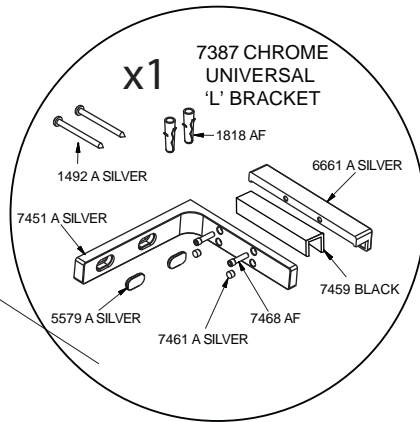
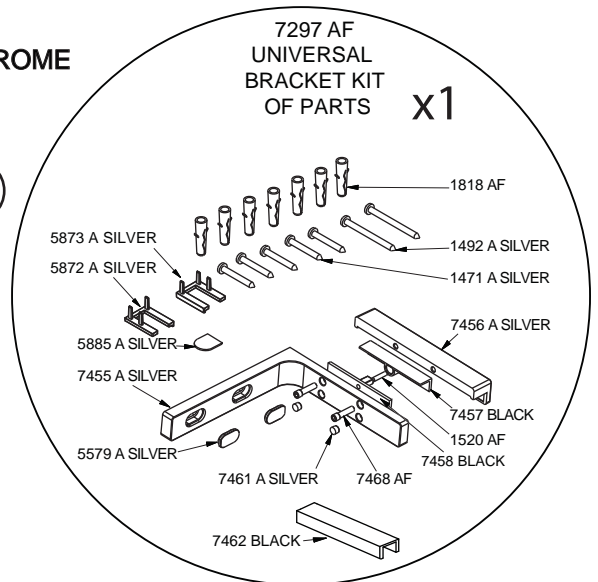
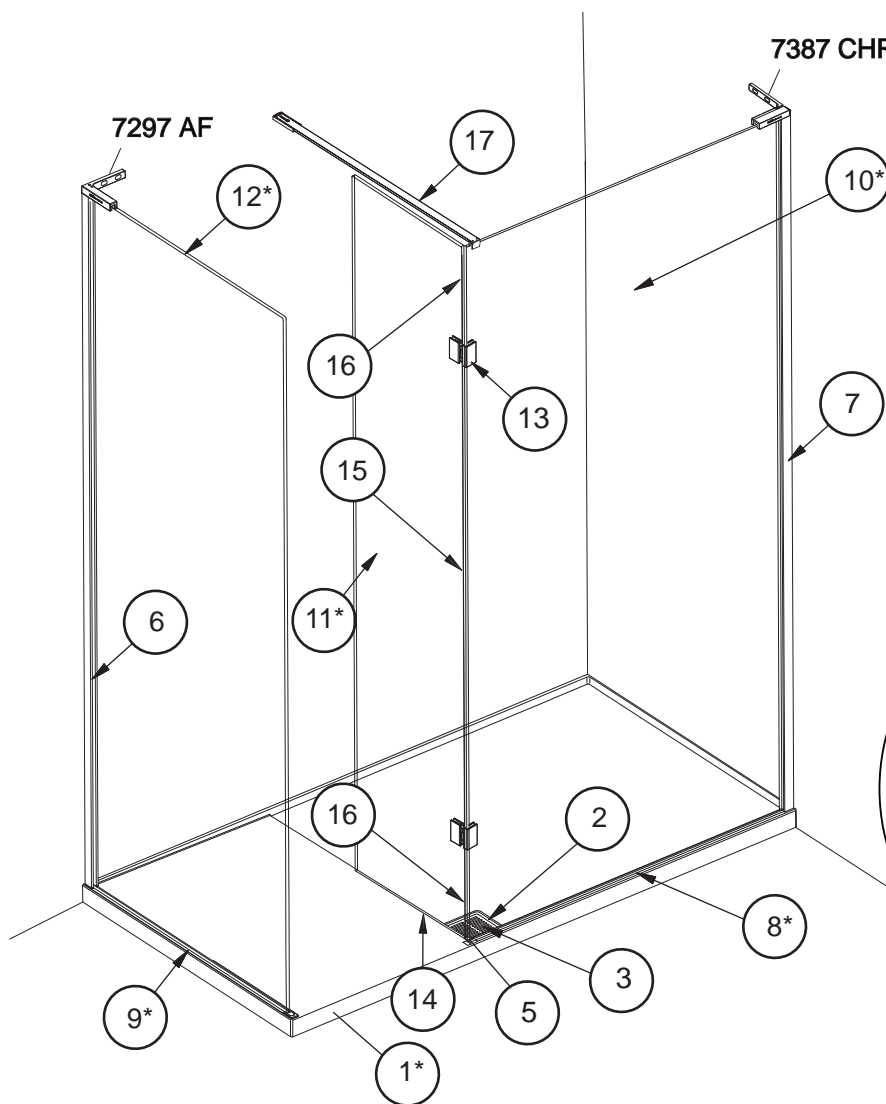

BOUTIQUE NW-H PARTS KIT 7296 AF.

PARTS LIST				
ITEM	DESCRIPTION	PART NUMBER	QTY	LENGTH
* 1	NWCC/H 1700 X 900 LH / RH		1	
	NWCC/H 1700 X 800 LH / RH		1	
	NWCC/H 1500 X 900 LH / RH		1	
	NWCC/H 1200 X 900 LH / RH		1	
2	SQUARE WASTE FLANGE	5861 A SILVER	1	
3	SQUARE TRAY GRILL	RR0000402		
4	FAST FLOW WASTE WITH 70mm FLANGE	7491 A SILVER	1	
5	CORNER TRAY CAP	5882 A SILVER	2	
6	END PANEL MOUNT	5794 A SILVER	1	1979mm
7	WALL MOUNT	5786 A SILVER	1	1982mm
* 8	FRONT PANEL TRAY GASKET			
	MODEL 1500	2369 WHITE	1	935mm
	MODEL 1700	2370 WHITE	1	1085mm
* 9	ENTRANCE SIDE PANEL TRAY GASKET			
	MODEL 800	2325 WHITE	1	759mm
	MODEL 900	2326 WHITE	1	859mm
* 10	FRONT PANEL GLASS			
	MODEL 1200	8191 M CLEAR/PLAIN	1	608mm
	MODEL 1500	8184 M CLEAR/PLAIN	1	908mm
	MODEL 1700	8185 M CLEAR/PLAIN	1	1058mm
11	HINGE PANEL GLASS			
		7678 M CLEAR/PLAIN	1	400mm
		8187 M CLEAR/PLAIN	1	450mm
		8188 M CLEAR/PLAIN	1	500mm
* 12	ENTRANCE SIDE PANEL GLASS			
	MODEL 800	7979 M CLEAR/PLAIN	1	2000 x 740mm
	MODEL 900	7978 M CLEAR/PLAIN	1	2000 x 840mm
13	NWH OPENING HINGE	7295 AF	2	
* 14	NWH HORIZONTAL SEAL 1500	2372 CLEAR	1	445mm
	NWH HORIZONTAL SEAL 1700	2373 CLEAR	1	495mm
15	BOUTIQUE CENTRE VERTICAL SEAL	2382 CLEAR	1	1196mm
16	BOUTIQUE VERTICAL SEAL	2383 CLEAR	2	376mm
17	BRACE BAR	7324 AF	1	

ITEM	DESCRIPTION	PART No.	QTY
1	WALL MOUNT TOP CAP	5869 A SILVER	1
2	CORNER EXTRUSION TOP CAP LH	5870 A SILVER	1
3	TRAY CLAMP COVER CAP	5885 A SILVER	1
4	CORNER EXTRUSION TOP CAP RH	5868 A SILVER	1
5	GLASS LEVELING BLOCK	5887 CLEAR	3
6	M4 x 8 CSK SOCKET HEAD SCREW	1499 A SILVER	1
7	WALL PLUG	1818 AF	5
8	No.8 x 32 PAN HEAD SELF TAPPING SCREW	1471 A SILVER	5
9	INSTALLATION INSTRUCTIONS	0964 AF	1
10	GARANTEE BOOKLET	1061 AF	1

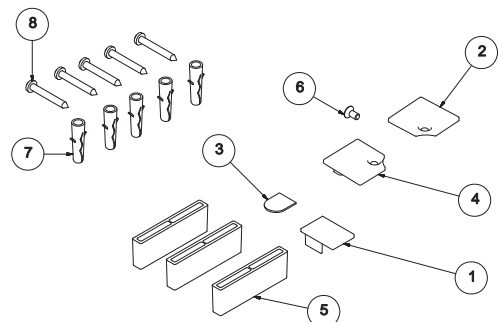

* ITEM VARIES DEPENDING ON MODEL